

SECTION H

APPENDICES

H1 LISTS OF PLAYS

1. 1950S TONY AWARD NOMINATED PLAYS
2. 1960S PLAYS
3. MUSICAL AMERICANA
- 4-5. OSCAR WINNING SCREENPLAYS (THRU 2003)
6. SHAKESPEARE'S CONTEMPORARIES
7. SUGGESTED LIST OF ABSURDIST PLAYWRIGHTS
8. MODERN PLAYS BASED ON SHAKESPEARE
9. SHAKESPEARE'S FLOWERS & HERBS—ALPHA BY FLOWER
10. SHAKESPEARE'S FLOWERS & HERBS—ALPHA BY PLAY
11. IRISH PLAYWRIGHTS
12. AMERICAN EXPERIENCE MUSICALS
- 13-14 PULITZER PRIZE WINNING PLAYS (THRU 2010)

H2 SAMPLE SCORE SHEETS

1. ACTING RUBRIC (SHARE SHEET)
2. ACTING ROUND BALLOT
3. SET/LIGHTS RUBRIC (SHARE SHEET)—FALL
4. SET/LIGHTS BALLOT—FALL
5. SET/LIGHTS/GRAPHICS RUBRIC (SHARE SHEET)—SHAKESPEARE
6. SET/LIGHTS/GRAPHICS BALLOT)—SHAKESPEARE
7. COSTUME RUBRIC (SHARE SHEET)
8. COSTUME BALLOT
9. GRAPHICS/PUBLICITY RUBRIC (SHARE SHEET)—FALL
10. GRAPHICS/PUBLICITY BALLOT—FALL
11. TABULATIONS KEY
12. SWEEPSTAKES POINTS

continued

SECTION H – TABLE OF CONTENTS – CONTINUED

H3 DTASC COMPUTER MANUAL

H4 CERTIFICATES

1. COMMUNITY SERVICE CERTIFICATE–FALL
2. COMMUNITY SERVICE CERTIFICATE–SHAKESPEARE
3. PARTICIPATION CERTIFICATE–FALL
4. PARTICIPATION CERTIFICATE–SHAKESPEARE

H5 FORMS

1. MEMBERSHIP
2. ASSOCIATE MEMBERSHIP
3. JUDGE SUBMISSIONS
4. RULES SUBMISSIONS
5. EVENT SUBMISSIONS
6. NOMINATION OF OFFICERS

H6 SAMPLE LETTERS – ALL AVAILABLE ON CD AS WORD DOCUMENTS (HOST LETTERS ARE IN SECTION C 1 AND ALSO ON THE CD)

1. LETTERHEAD
2. SAMPLE LETTER TO ADMINISTRATOR OF PARTICIPATING SCHOOL
3. SAMPLE LETTER TO ADMINISTRATOR OF PARTICIPATING SCHOOL
4. SAMPLE THANK YOU LETTER TO FESTIVAL HOST
5. SAMPLE THANK YOU LETTER FOR SALUTE TO THE WINNERS

H7 OTHER ITEMS OF INTEREST

1. WHY TEACH THEATRE IN OUR SCHOOLS
2. THERE’S NO DATA LIKE SHOW DATA

continued

SECTION H – TABLE OF CONTENTS – CONTINUED

H8 MAPS OF SCHOOLS

1. AVIARA OAKS MIDDLE SCHOOL, CARLSBAD
2. BIRMINGHAM HIGH SCHOOL, VAN NUYS
3. CALABASAS HIGH SCHOOL, CALABASAS
4. CALIFORNIA HIGH SCHOOL, WHITTIER
5. CHATSWORTH HIGH SCHOOL, CHATSWORTH
6. CITRUS HILL HIGH SCHOOL, PERRIS
7. COLONY HIGH SCHOOL, ONTARIO
8. DODSON MIDDLE SCHOOL, RANCHO PALOS VERDES
9. FULLERTON UNION HIGH SCHOOL, FULLERTON
10. JOHN BURROUGHS HIGH SCHOOL, BURBANK
11. MILLIKAN MIDDLE SCHOOL, SHERMAN OAKS
12. ORVILLE WRIGHT MIDDLE SCHOOL, WESTCHESTER
13. PALISADES HIGH SCHOOL, PACIFIC PALISADES
14. RAMON C. CORTINES VAPA, LOS ANGELES
15. RESEDA HIGH SCHOOL, RESEDA
16. SHERMAN OAKS CENTER FOR ENRICHED STUDIES, RESEDA
17. ST. JOSEPH’S HIGH SCHOOL, LAKEWOOD
18. SUN VALLEY MIDDLE SCHOOL, SUN VALLEY
19. VALENCIA HIGH SCHOOL, PLACENTIA
20. VALLEY VIEW MIDDLE SCHOOL, SIMI VALLEY
21. WOODROW WILSON MIDDLE SCHOOL, GLENDALE

H9 UNASSIGNED

H10 MISCELLANEOUS

1. IN AND AROUND HOLLYWOOD—RESTAURANTS
2. MAP SHOWING LOCATION OF ABOVE RESTAURANTS

LIST OF 1950s TONY AWARD NOMINATED PLAYS

The Apple Cart	A Moon for the Misbegotten
Auntie Maine	
	No Time for Sergeants
The Bad Seed	
A Boy Growing Up	Once Upon a Tailor
Bus Stop	Ondine
Cat on a Hot Tin Roof	Picnic
The Cave Dwellers	The Pleasure of His Company
The Chalk Garden	Point of No Return
The Cocktail Party	The Ponder Heart
Come Back Little Sheba	The Potting Shed
The Country Girl	
The Crucible	Quadrille
The Dark at the Top of the Stairs	The Reluctant Debutante
Darkness at Noon	Romanoff and Juliet
The Desperate Hours	The Rope Dancers
Dial M for Murder	The Rose Tattoo
The Diary of Anne Frank	
The Entertainer	Separate Tables
	The Seven Year Itch
	The Shrike
The Fourposter	Six Characters in Search of an Author
	Someone Waiting
The Great Sebastians	Stalag 17
	Sunrise at Campobello
The Happiest Millionaire	Tamburlaine the Great
A Hatful of Rain	Tea and Sympathy
The Honeys	The Teahouse of the August Moon
	Tiger at the Gates
I am a Camera	Time of the Cuckoo
Inherit the Wind	Time Remembered
The Innocents	The Trip to Bountiful
	Two for the Seesaw
J.B.	
The Lark	A View from the Bridge
Long Day's Journey into Night	The Visit
Look Back in Anger	A Visit to a Small Planet
Look Homeward Angel	
A Majority of One	The Waltz of the Toreadors
The Matchmaker	Witness for the Prosecution
Middle of the Night	

1960s PLAYS

After the Fall
All the Way Home
The Andersonville Trial

Barefoot in the Park
Becket
The Best Man
Black Comedy

Cactus Flower
The Caretaker

The Devil's Advocate

Enter Laughing

Forty Carats

Gideon
The Great White Hope
Goodbye Charlie

The Hostage

I Never Sang for My Father

Joe Egg

The Lion in Winter
Luther
Luv

A Man for all Seasons
Marat/Sade

Marathon '33
The Miracle Worker

Night of the Iguana
Never Too Late

The Odd Couple (male version)
The Owl and the Pussycat

A Passage to India
Play It Again, Sam
Plaza Suite
The Prime of Miss Jean Brodie
Purlie Victorious

Raisin in the Sun
Rosenkrantz and Guildenstern are Dead

A Shot in the Dark
Slow Dance on the Killing Ground
The Subject Was Roses
Sweet Bird of Youth

Take Her She's Mine
The Tenth Man
A Thousand Clowns
Toys in the Attic

Wait Until Dark
Who's Afraid of Virginia Woolf

You Know I Can't Hear You When the
Water's Running

MUSICAL AMERICANA

110 in the Shade
1776
42nd Street

A Chorus Line
Annie
Applause
Assassins

Barnum
Bells Are Ringing
The Best Little Whore House in Texas
Big River
Boy Friend, The
Bye, Bye Birdie

Chicago
Company

Damn Yankees
Destry Rides Again
Dreamgirls

Finian's Rainbow
Fiorello!
Flower Drum Song
Funny Girl

George M!
Golden Boy
Grease
Guys and Dolls
Gypsy

Hair
Hello Dolly
How to Succeed in Business Without Really
Trying

Kiss Me Kate

Mack and Mabel
Mame
Me and My Girl
The Me Nobody Knows
The Most Happy Fellow
The Music Man
My One and Only

No, No Nanette

Oklahoma
On a Clear Day You Can See Forever

The Pajama Game
Porgy and Bess
The Producers
Promises, Promises

Quilters

Ragtime
Runaways

Seven Brides for Seven Brothers
She Loves Me
Singin' in the Rain
South Pacific
Sugar
Sunset Blvd.
Superman
Sweet Charity

Take Me Along
The Unsinkable Molly Brown

West Side Story
Wonderful Town
Working
You're a Good Man Charlie Brown

OSCAR WINNING ORIGINAL SCREENPLAYS

- 1927 Benjamin Glazer (Seventh Heaven)
1928 Hans Kraly (The Patriot)
1929 Frances Marion (The Big House)
1930 John Monk Saunders (The Dawn Patrol)
1931 Frances Marion (The Champ)
1932 Robert Lord (One Way Passage)
1934 Arthur Caesar (Manhattan Melodrama)
1935 Ben Hecht, Charles MacArthur (The Scoundrel)
1936 Pierre Collings, Sheridan Gibney (The Story of Louis Pasteur)
1937 William A. Wellman, Robert Carson (A Star Is Born)
1938 Eleanore Griffin, Dore Schary (Boys Town)
1939 Lewis R. Foster (Mr. Smith Goes to Washington)
1940 Preston Sturges (The Great McGinty)
1941 Herman J. Mankiewicz, Orson Welles (Citizen Kane)
1942 Michael Kanin, Ring Lardner, Jr. (Woman of the Year)
1943 Norman Krasna (Princess O'Rourke)
1944 Lamar Trotti (Wilson)
1945 Richard Schweizer (Marie-Louise)
1946 Muriel and Sydney Box (The Eleventh Veil)
1947 Sidney Sheldon (The Bachelor and the Bobby-Soxer)
1948 Richard Schweizer and David Wechsler (The Search)
1949 Robert Pinosh (Battleground)
1950 Joseph L Mankiewicz (All About Eve)
1951 Alan Jay Lemer (An American in Paris)
1952 T.E.B. Clarke (The Lavender Hill Mob)
1953 Charles Brackett, Walter Reisch and Richard Breen (Titanic)
1954 Budd Schulberg (On the Waterfront)
1955 William Ludwig and Sonya Levien (Interrupted Melody)
1956 Albert Lamorrisse (The Red Balloon)
1957 George Wells (Designing Woman)
1958 Nathan E. Douglas and Harold Jacob Smith (The Defiant Ones)
1959 Russell Rouse & Clarence Green; Stanley Shapiro & Maurice Richlin (Pillow Talk)
1960 Billy Wilder and I.A.L. Diamond (The Apartment)
1961 William Inge (Splendor in the Grass)
1962 Ennio de Concini, Alfredo Giannetti and Pietro Germi (Divorce—Italian Style)
1963 James R. Webb (How the West Was Won)
1964 S.H. Barnett; Peter Stone and Frank Tarloff (Father Goose)
1965 Frederic Raphael (Darling)
1966 Claude Lelouch and Pierre Uytterhoeven (A Man and A Woman)
1967 William Rose (Guess Who's Coming to Dinner)

continued

OSCAR WINNING SCREENPLAYS, CONTINUED

1968 Mel Brooks (The Producers)
1969 William Goldman (Butch Cassidy and the Sundance Kid)
1970 Francis Ford Coppola and Edmund H. North (Patton)
1971 Paddy Chayefsky (The Hospital)
1972 Jeremy Lerner (The Candidate)
1973 David S. Ward (The Sting)
1974 Robert Towne (Chinatown)
1975 Frank Pierson (Dog Day Afternoon)
1976 William Goldman (All the President's Men)
1977 Woody Allen and Marshall Brickman (Annie Hall)
1978 Nancy Dowd, Waldo Salt and Robert C. Jones (Coming Home)
1979 Steve Tesich (Breaking Away)
1980 Bo Goldman (Melvin and Howard)
1981 Colin Welland (Chariots of Fire)
1982 John Briley (Gandhi)
1983 Horton Foote (Tender Mercies)
1984 Robert Benton (Places in the Heart)
1985 Earl W. Wallace, William Kelley, Pamela Wallace (Witness)
1986 Woody Allen (Hannah and Her Sisters)
1987 John Patrick Shanley (Moonstruck)
1988 Ronald Bass and Barry Morrow (Rain Man)
1989 Tom Schulman (Dead Poets Society)
1990 Bruce Joel Rubin (Ghost)
1991 Callie Khouri (Thelma and Louise)
1992 Neil Jordon (The Crying Game)
1993 Jane Champion (The Piano)
1994 Quentin Tarantino and Roger Avary (Pulp Fiction)
1995 Quentin Tarantino and Roger Avary (The Usual Suspects)
1996 Ben Affleck and Matt Damon (Good Will Hunting)
1997 Ethan and Joel Cohen (Fargo)
1998 Marc Normand and Tom Stoppard (Shakespeare in Love)
1999 Alan Ball (American Beauty)
2000 Cameron Crowe (Almost Famous)
2001 Julian Fellowes (Gosford Park)
2002 Pedro Almodóvar (Talk to Her)
2003 Sofia Coppola (Lost in Translation)

SHAKESPEARE'S CONTEMPORARIES

Plays Written between 1564–1616

George Chapman (1559–1634)*

Bussy d'Ambois

All Fools

The Gentleman Usher

May Day

John Marston (1576–1634)*

The Malcontent

The Dutch Courtesan

John Fletcher (1579–1625)*

The Faithful Shepherdess

Philaster

A Maid's Tragedy

Francis Beaumont (c. 1584–1616)*

Thomas Heywood (c. 1570–1641)*

A Woman Killed With Kindness

Thomas Dekker (1572–1632)*

John Fletcher (1579–1625)

Thomas Kyd (1558–1616)

The Spanish Tragedy

Christopher Marlowe (1564–1593)

Jew of Malta

Edward II

Tamburlane the Great

The History of Doctor Faustus

John Webster (1580–1630)

Duchess of Malfi

The White Devil

Ben Jonson

The Alchemist

Every Man in his Humour

Volpone

Cyril Tourneur

The Revenger's Tragedy

John Ford

'Tis a Pity She's a Whore

James Shirley

Cupid and Death

Collaborations: George Chapman wrote many plays in collaboration. Eastward Ho!

(1605), written with Ben Jonson and John Marston, contained satirical references to the Scots which landed the authors in jail. Rollo Duke of Normandy (date uncertain), was written with Fletcher, Jonson and Massinger.

Beaumont and Fletcher Collaborations

1. *Knight of the Burning Pestle, The*. 1607. Comedy notable for using an audience member as a participant.
2. *Philaster*. 1610.
3. *Maid's Tragedy, The*. 1611. Tragicomedy built around lust and corruption in the court of Rhodes. Considered one of Beaumont and Fletcher's best.
4. *King and No King, A*. 1611.
5. *Scornful Lady, The*. 1613.

SUGGESTED LIST OF ABSURDIST PLAYWRIGHTS

Theatre of the Absurd — plays that revolve around the similar theme that life is meaningless. It is usually unrealistic, unconventional, and dependent on clever dialogue or banter. While many of the plays described by this title seem to be quite random and meaningless on the surface, an underlying structure and meaning is usually found in the midst of the chaos.

Samuel Beckett

Harold Pinter

Edward Albee

Christopher Durang

Eugene Ionesco

Tom Stoppard

Luigi Pirandello

Jean-Paul Sartre

Albert Camus

Jean Genet

Arthur Adamov

Friedrich Durrenmatt

Fernando Arrabal

Jean Tardieu

Dario Fo

David Mamet

Norman Frederick Simpson

Jack Gelber

Arthur Kopit

Slawomir Mrozek

Tadeusz Rozewicz

Vaclav Havel

John Guare

Caryl Churchill

Gao Xingjian

Jules Feiffer

Antonin Artaud

Boris Vian

Peter Weiss

MODERN PLAYS BASED ON SHAKESPEARE

Actor's Nightmare (one section of it)
Boys from Syracuse
Cahoot's Macbeth
Complete Works of Shakespeare
Dogg's Hamlet
Goodnight Desdemona
Hamlet Cha-Cha-Cha
Hamlet-Machine
I Hate Hamlet
I Hate Shakespeare
Kiss Me Kate
Macbett
MacBird
Rosenkrantz and Guildenstern Are Dead
The Golem, Methuselah and Shylock
Two Gentlemen of Verona (modern translation)
Want's Unwished Work
West Side Story

SHAKESPEARE'S FLOWERS AND HERBS

ALPHABETICAL BY FLOWER

Flower or Herb	Play	Act	Scene
Belladonna	Romeo & Juliet	II	iii
Blackberry	As You Like It	III	ii
Bluebell	Cymbeline	IV	ii
Broom	Tempest	IV	i
Burdock	King Lear	IV	iv
Buttercup/ Cuckoo-buds	Love's Labour's Lost	V	ii
Camomile	Henry IV (I)	II	iv
Carnation	Winter's Tale	IV	iii
Cherry	Midsummer Night's Dream	III	ii
Clover	Henry V	V	ii
Columbine:	Love's Labour's Lost	V	ii
Cowslip	Tempest	V	i
Crab Apple	Midsummer Night's Dream	II	i
Crow-Flower	Hamlet	IV	vii
Crown Imperial	Winter's Tale	IV	iii
Daffodil	Winter's Tale	IV	ii
Daisy	Love's Labour's Lost	V	ii
Eglantine	Midsummer Night's Dream	II	i
Fennel	Hamlet	IV	v
Florentine Iris	Henry V	V	ii
Flower-De-Luce (Fleur de lys)	Henry VI (I)	I	i
Heartsease (Pansy)	Hamlet	IV	v
Hemlock	Macbeth	IV	i
Honeysuckle	Midsummer Night's Dream	IV	i
Hyssop	Othello	I	iii
Iris, Florentine	Henry V	V	ii
Lady-Smock	Love's Labour's Lost	V	ii
Lancaster Rose	Henry VI (I)	II	iv
Lavender	Winter's Tale	IV	iii
Lily	King John	IV	ii

Flower or Herb	Play	Act	Scene
Marigold	Winter's Tale	IV	iii
Marjoram, Sweet	All's Well That Ends Well	IV	v
Marjoram, Wild	Winter's Tale	IV	iii
Mint	Winter's Tale	IV	iii
Monkshood	Henry VI (II)	IV	iv
Musk-Rose	Midsummer Night's Dream	IV	i
Nettle	Richard II	III	ii
Oak	Midsummer Night's Dream	II	i
Oxlip	Midsummer Night's Dream	II	i
Pansy (Heartsease)	Hamlet	IV	v
Pomegranate	Romeo & Juliet	III	v
Poppy	Othello	III	iii
Rose	Romeo & Juliet	II	ii
Rose, Lancaster	Henry VI (I)	II	iv
Rose, York	Henry VI (I)	II	iv
Rosemary	Hamlet	IV	v
Rue	Richard II	III	iv
Rushes	Henry IV (I)	III	i
Savory	Winter's Tale	IV	iii
Strawberry	Henry V	I	i
Sweet Marjoram	All's Well That Ends Well	IV	v
Thistle	Much Ado About Nothing	III	iv
Thyme, Wild	Midsummer Night's Dream	II	i
Vetch	Tempest	IV	i
Vine	Tempest	IV	i
Violet	Cymbeline	IV	ii
Wild Marjoram	Winter's Tale	IV	iii
Wild Thyme	Midsummer Night's Dream	II	i
Wormwood	Midsummer Night's Dream	IV	i
York Rose	Henry VI (I)	II	iv

continued

SHAKESPEARE'S FLOWERS AND HERBS

ALPHABETICAL BY PLAY

Flower or Herb	Play	Act	Scene
Sweet Marjoram	All's Well That Ends Well	IV	v
Blackberry	As You Like It	III	ii
Bluebell	Cymbeline	IV	ii
Violet	Cymbeline	IV	ii
Fennel	Hamlet	IV	v
Pansy (Heartsease)	Hamlet	IV	v
Rosemary	Hamlet	IV	v
Crow-Flower	Hamlet	IV	vii
Camomile	Henry IV (I)	II	iv
Rushes	Henry IV (I)	III	i
Strawberry	Henry V	I	i
Clover	Henry V	V	ii
Florentine Iris	Henry V	V	ii
Flower-De-Luce (Fleur de lys)	Henry VI (I)	I	i
Lancaster Rose	Henry VI (I)	II	iv
York Rose	Henry VI (I)	II	iv
Monkshood	Henry VI (II)	IV	iv
Lily	King John	IV	ii
Burdock	King Lear	IV	iv
Buttercup/ Cuckoo-buds	Love's Labour's Lost	V	ii
Columbine:	Love's Labour's Lost	V	ii
Daisy	Love's Labour's Lost	V	ii
Lady-Smock	Love's Labour's Lost	V	ii
Hemlock	Macbeth	IV	i

Flower or Herb	Play	Act	Scene
Crab Apple	Midsummer Night's Dream	II	i
Eglantine	Midsummer Night's Dream	II	i
Oak	Midsummer Night's Dream	II	i
Oxlip	Midsummer Night's Dream	II	i
Wild Thyme	Midsummer Night's Dream	II	i
Cherry	Midsummer Night's Dream	III	ii
Honeysuckle	Midsummer Night's Dream	IV	i
Musk-Rose	Midsummer Night's Dream	IV	i
Wormwood	Midsummer Night's Dream	IV	i
Thistle	Much Ado About Nothing	III	iv
Hyssop	Othello	I	iii
Poppy	Othello	III	iii
Nettle	Richard II	III	ii
Rue	Richard II	III	iv
Rose	Romeo & Juliet	II	ii
Belladonna	Romeo & Juliet	II	iii
Pomegranate	Romeo & Juliet	III	v
Broom	Tempest	IV	i
Vetch	Tempest	IV	i
Vine	Tempest	IV	i
Cowslip	Tempest	V	i
Daffodil	Winter's Tale	IV	ii
Carnation	Winter's Tale	IV	iii
Crown Imperial	Winter's Tale	IV	iii
Lavender	Winter's Tale	IV	iii
Marigold	Winter's Tale	IV	iii
Mint	Winter's Tale	IV	iii
Savory	Winter's Tale	IV	iii
Wild Marjoram	Winter's Tale	IV	iii

IRISH PLAYWRIGHTS*

John Banim (1798–1842)
Sebastian Barry (b. 1955)
Samuel Beckett (1906–1989)
Brendan Behan (1923–1964)
Dermot Bolger (b. 1959)
Dion Boucicault (1820–1890)
Colm Byrne (b. 1971)
Marina Carr (b. 1964)
Austin Clarke (1896–1974)
Padraic Colum (1881–1972)
Roddy Doyle (b. 1958)
Gary Duggan (b. 1979)
Lord Dunsany (1878–1957)
St John Ervine (1883–1971)
Bernard Farrell (b. 1939)
Brian Friel (b. 1929)
Miriam Gallagher (b. 1958)
Oliver Goldsmith (1730–1774)
Lady Augusta Gregory (1852–1932)
Michael Harding (b. 1953)
Denis Johnston (1901–1984)
Jennifer Johnston (b. 1930)
Marie Jones (b. 1951)
John B. Keane (1928–2002)
Thomas Kilroy (b. 1934)
Hugh Leonard (1926–2009)
Walter Macken (1915–1967)
Martin McDonagh (b. 1970)
Frank McGuinness (b. 1953)
Conor McPherson (b. 1971)
M. J. Molloy (1917–1994)
George Moore 1852–1933)
Jimmy Murphy (b. 1962)
John Murphy (1929–1998)
Tom Murphy (b. 1935)
T. C. Murray (1873–1959)
Sean O’Casey (1880–1964)
Joseph O’Connor (b. 1963)
Mark O’Rowe (b. 1970)
Lennox Robinson (1886–1958)
Billy Roche (b. 1949)
G. Bernard Shaw (1856–1950)
Peter Sheridan (b. 1952)
George Shiels (1881–1949)
Richard Brinsley Sheridan (1751–1816)
John Millington Synge (1871–1909)
Colin Teevan (b. 1968)
Enda Walsh (b. 1967)
Oscar Wilde (1845–1900)
W.B. Yeats (1865–1939)

* If you wish to use a play by an Irish playwright not on this list, contact Sue Freitag for approval: Tchdafutr@aol.com

AMERICAN EXPERIENCE MUSICALS*

Title (year first produced—setting)

Crazy For You (NYC and the American West settings)

Annie (NYC)

Oh, Boy (1917—takes place in Meadowsides, New York)

Hello Dolly (Yonkers, New York)

Lady Be Good (1924—takes place in Beacon Hills, New England. The musical that made Hollywood notice Fred Astaire.)

No, No Nanette (1925—no specific location but the plot is the Bible versus the flappers)

Oh, Kay (1926—Long Island, New York)

Showboat (1927—The American South—Mississippi River)

Of Thee I Sing (1931—set around a Presidential campaign)

Anything Goes (1934—American and British passengers on an ocean liner)

Annie Get Your Gun (1946—Ohio and other parts of the country)

South Pacific (1949—American troops in World War II Pacific Islands)

How To Succeed in Business Without Really Trying (1961—any major US city)

Pal Joey (1940—set in Chicago)

Miss Saigon (1991—American troops in Vietnam)

Chicago (1987—set in women's prison outside Chicago)

Oklahoma (1943—it is obvious)

On the Town (1944—NYC)

Carousel (1945—New England)

Kiss Me Kate (1947—Baltimore)

Guys and Dolls (1950—NYC)

Damn Yankees (1955—Washington DC)

The Music Man (1957—Iowa)

West Side Story (1957—NYC)

Gypsy (1959—Seattle and other cities)

Bye Bye Birdie (1960—Sweetapple, Ohio)

Funny Girl (1964—NYC)

Sweet Charity (1966—NYC)

Hair (1969—NYC)

Company (1970—NYC)

Grease (1972—Rydell High School)

A Chorus Line (1975—NYC)

On the Twentieth Century (1978—Chicago)

42nd Street (1980—NYC)

Dreamgirls (1981—Detroit)

Big River (1985—Mississippi River)

City of Angels (1989—Los Angeles)

Sunset Boulevard (1994—Hollywood)

In the Heights

Memphis

Ragtime

Tintypes

Thoroughly Modern Millie

Assassins

Parade

All American

Take Me Along

Promises, Promises

Company

High School Musical

Little House on the Prairie

Caddie Woodlawn

* Must be the American Experience — be prepared to justify your choice to Rules.

PULITZER PRIZE WINNING PLAYS*

Year: Title – Author

- 1920: Beyond the Horizon – Eugene O’Neill
1921: Miss Lulu Bett – Zona Gale
1922: Anna Christie – Eugene O’Neill
1923: Icebound – Owen Davis
1924: Hell-Bent Fer Heaven – Hatcher Hughes
1925: They Knew What They Wanted – Sidney Howard
1926: Craig’s Wife – George Kelly
1927: In Abraham’s Bosom – Paul Green
1928: Strange Interlude – Eugene O’Neill
1929: Street Scene – Elmer Rice
1930: The Green Pastures – Marc Connelly
1931: Alison’s House – Susan Glaspell
1932: Of Thee I Sing – George S. Kaufman, Morrie Ryskind, Ira Gershwin,
1933: Both Your Houses – Maxwell Anderson
1934: Men in White – Sidney Kingsley
1935: The Old Maid – Zoe Akins
1936: Idiot’s Delight – Robert E. Sherwood
1937: You Can’t Take it with You – Moss Hart, George S. Kaufman
1938: Our Town – Thornton Wilder
1939: Abe Lincoln in Illinois – Robert E. Sherwood
1940: The Time of Your Life – William Saroyan
1941: There Shall Be No Night – Robert E. Sherwood
1942: no award
1943: The Skin of Our Teeth – Thornton Wilder
1944: no award
1945: Harvey – Mary Coyle Chase
1946: State of the Union – Russel Crouse, Howard Lindsay
1947: no award
1948: A Streetcar Named Desire – Tennessee Williams
1949: Death of a Salesman – Arthur Miller
1950: South Pacific – Richard Rodgers, Oscar Hammerstein II, Joshua Logan
1951: no award
1952: The Shrike – Joseph Kramm
1953: Picnic – William Inge
1954: The Teahouse of the August Moon – John Patrick
1955: Cat on a Hot Tin Roof – Tennessee Williams
1956: The Diary of Anne Frank – Albert Hackett and Frances Goodrich
1957: Long Day’s Journey into Night – Eugene O’Neill
1958: Look Homeward, Angel – Ketti Frings
1959: J.B. – Archibald MacLeish
1960: Fiorello! – Jerome Weidman and George Abbott Jerry Bock, and Sheldon Harnick
1961: All the Way Home – Tad Mosel
1962: How to Succeed in Business Without Really Trying – Frank Loesser and Abe Burrows
1963 and 1964: no award *continued*

* As there is a musical category (Event 6), only the libretto of a musical may be used.

PULITZER PRIZE WINNING PLAYS, CONTINUED

- 1965: The Subject Was Roses – Frank D. Gilroy
1966: no award
1967: A Delicate Balance – Edward Albee
1968: no award
1969: The Great White Hope – Howard Sackler
1970: No Place to be Somebody – Charles Gordone
1971: The Effect of Gamma Rays on Man-in-the-Moon Marigolds – Paul Zindel
1972: no award
1973: That Championship Season – Jason Miller
1974: no award
1975: Seascape – Edward Albee
1976: A Chorus Line – Michael Bennett, Nicholas Dante and James Kirkwood, Jr.,
Marvin Hamlisch and Edward Kleban
1977: The Shadow Box – Michael Cristofer
1978: The Gin Game – Donald L. Coburn
1979: Buried Child – Sam Shepard
1980: Talley’s Folly – Lanford Wilson
1981: Crimes of the Heart – Beth Henley
1982: A Soldier’s Play – Charles Fuller
1983: ’night, Mother – Marsha Norman
1984: Glengarry Glen Ross – David Mamet
1985: Sunday in the Park with George – James Lapine and Stephen Sondheim
1986: no award
1987: Fences – August Wilson
1988: Driving Miss Daisy – Alfred Uhry
1989: The Heidi Chronicles – Wendy Wasserstein
1990: The Piano Lesson – August Wilson
1991: Lost in Yonkers – Neil Simon
1992: The Kentucky Cycle – Robert Schenkkan
1993: Angels in America: Millennium Approaches – Tony Kushner
1994: Three Tall Women – Edward Albee
1995: The Young Man From Atlanta – Horton Foote
1996: Rent – Jonathan Larson
1997: no award
1998: How I Learned to Drive – Paula Vogel
1999: Wit – Margaret Edson
2000: Dinner with Friends – Donald Margulies
2001: Proof – David Auburn
2002: Topdog/Underdog – Suzan-Lori Parks
2003: Anna in the Tropics – Nilo Cruz
2004: I Am My Own Wife – Doug Wright
2005: Doubt: A Parable – John Patrick Shanley
2006: no award
2007: Rabbit Hole – David Lindsay-Abaire
2008: August: Osage County – Tracy Letts
2009: Ruined – Lynn Nottage
2010: Next to Normal – music by Tom Kitt, book and lyrics by Brian Yorkey

Acting Ballot



**Drama Teachers Association of
Southern California**

Event Number _____

Event Name _____

Room _____

Round 1 2 Semi-Finals Finals

Instructions

1. Fill in Event and Room Number and circle the round.
2. Copy the school codes in the order of performance the room chair has listed on the board.
3. Watch the scenes and make comments on the share sheet provided for student feedback.
4. Then assign a letter for the quality in each category. Use the following abbreviations:
S=Superior (Grade=A) **E=Excellent** (Grade =B) **G=Good** (Grade =C) **F=Fair** (Grade =D) **NI=Needs Improvement** (Grade =Fail) **X=No Show**
5. After you have scored all the scenes, rank them from best (1) to worst (12) in the RANK column.
6. **SIGN YOUR BALLOT** (the festival cannot continue without all ballots being signed)
7. Place in the envelope, and bring it and your share sheets directly to Tabulations.

You must score in every category for every event

ORDER OF PERFORMANCE	SCHOOL CODE	Judges Notes:	STAGING	SCENE STRUCTURE AND ACTING FUNDAMENTALS	CHARACTERIZATION	INTERACTION	AGE APPROPRIATENESS	RANK	NOT APPROPRIATE
EX:	WZ20		E	G	E	S	I	3	✓
1									
2									
3									
4									
5									
6									
7									
8									
9									
10									
11									
12									
Judge's Name (print)			Judge Number						
Judge's Signature			Cell Phone Number						

Costume Ballot



Drama Teachers Association
of Southern California

Event Number

Event Name

Room

Round 1 2 Semi-Finals Finals

Instructions

1. Fill in Event and Room Number and circle the round.
2. Copy the school codes in the order of performance the room chair has listed on the board.
3. Watch the scenes and make comments on the share sheet provided for student feedback.
4. Then assign a letter for the quality in each category. Use the following abbreviations:
S=Superior (Grade=A) **E=Excellent** (Grade =B) **G=Good** (Grade =C) **F=Fair** (Grade =D) **NI=Needs Improvement** (Grade =Fail) **X=No Show**
5. After you have scored all the scenes, rank them from best (1) to worst (45) in the RANK column.
6. **SIGN YOUR BALLOT** (the festival cannot continue without all ballots being signed)
7. Place in the envelope, and bring it and your share sheets directly to Tabulations.

You must score in every category for every event

ORDER OF PERFORMANCE	SCHOOL CODE	Judges Notes:	RESEARCH	PATTERN, FABRIC, AND COLOR CHOICES	COSTUME DESIGN	COSTUME CONSTRUCTION	OVERALL PRESENTATION	RANK	NOT APPROPRIATE
EX:	WZ20		E	G	E	S	I	3	√
1									
2									
3									
4									
5									
6									
7									
8									
9									
10									
11									
12									
Judge's Name (print)			Judge Number						
Judge's Signature			Cell Phone Number						

13									
14									
15									
16									
17									
18									
19									
20									
21									
22									
23									
24									
25									
26									
27									
28									
29									
30									
31									
32									
33									
34									
35									
36									
37									
38									
39									
40									
41									
42									
43									
44									
45									



**Drama Teachers Association
of Southern California**

Costume Share Sheet

Event Number

Event Name

Room

Round

1

2

Semi-Finals

School Code

Title

Comments

Please write constructive comments in the space provided. Coaches and students review these forms as a tool for learning.

Multiple empty horizontal lines for writing comments.

Areas of Evaluation

You must mark EVERY category in EVERY performance

Research

Knowledge of the chosen play and time period

Superior

Excellent

Good

Fair

Needs Work

Pattern, Fabric And Color Choices

Required paperwork, color choices, appropriateness, overall display

Superior

Excellent

Good

Fair

Needs Work

Costume Design

Presentation and professionalism of designs

Superior

Excellent

Good

Fair

Needs Work

Costume Construction

Workmanship and construction technique

Superior

Excellent

Good

Fair

Needs Work

Overall Presentation

Professionalism of presenters, overall preparation, clear speech

Superior

Excellent

Good

Fair

Needs Work

Judge Number

Judge Name

Judge Signature



Sets and Lights Ballot

Instructions

1. Fill in Event and Room Number and circle the round.
2. Copy the school codes in the order of performance the room chair has listed on the board.
3. Watch the scenes and make comments on the share sheet provided for student feedback.
4. Then assign a letter for the quality in each category. Use the following abbreviations:
S=Superior (Grade=A) **E=Excellent** (Grade =B) **G=Good** (Grade =C) **F=Fair** (Grade =D) **NI=Needs Improvement** (Grade =Fail) **X=No Show**
5. After you have scored all the scenes, rank them from best (1) to worst (45) in the RANK column.
6. **SIGN YOUR BALLOT** (the festival cannot continue without all ballots being signed)
7. Place in the envelope, and bring it and your share sheets directly to Tabulations.

You must score in every category for every event

ORDER OF PERFORMANCE	SCHOOL CODE	Judges Notes:	RESEARCH	CONCEPT	SET DESIGN	LIGHTING DESIGN	OVERALL PRESENTATION	RANK	NOT APPROPRIATE
EX:	WZ20		E	G	E	S	G	3	✓
1									
2									
3									
4									
5									
6									
7									
8									
9									
10									
11									
12									
Judge's Name (print)			Judge Number						
Judge's Signature			Cell Phone Number						

13									
14									
15									
16									
17									
18									
19									
20									
21									
22									
23									
24									
25									
26									
27									
28									
29									
30									
31									
32									
33									
34									
35									
36									
37									
38									
39									
40									
41									
42									
43									
44									
45									



Sets and Lights Share Sheet

Comments

Please write constructive comments in the space provided. Coaches and students review these forms as a tool for learning.

Multiple empty horizontal lines for writing comments.

Areas of Evaluation

You must mark EVERY category in EVERY performance

Research

Knowledge of the chosen play and time period

Superior

Excellent

Good

Fair

Needs Work

Concept

Required paperwork, color choices, appropriateness, overall display

Superior

Excellent

Good

Fair

Needs Work

Set Design

Set—Practicality and professionalism of design/model

Superior

Excellent

Good

Fair

Needs Work

Lighting Design

Lighting—Required paperwork, instrument choices, display

Superior

Excellent

Good

Fair

Needs Work

Overall Presentation

Professionalism of presenters, overall preparation, clear speech

Superior

Excellent

Good

Fair

Needs Work

Judge Number

Judge Name

Judge Signature

Sets, Lights, and Graphics Ballot



**Drama Teachers Association
of Southern California**

Event Number _____

Event Name _____

Room _____

Round 1 2 Semi-Finals Finals

Instructions

1. Fill in Event and Room Number and circle the round.
2. Copy the school codes in the order of performance the room chair has listed on the board.
3. Watch the scenes and make comments on the share sheet provided for student feedback.
4. Then assign a letter for the quality in each category. Use the following abbreviations:
S=Superior (Grade=A) **E=Excellent** (Grade =B) **G=Good** (Grade =C) **F=Fair** (Grade =D) **NI=Needs Improvement** (Grade =Fail) **X=No Show**
5. After you have scored all the scenes, rank them from best (1) to worst (45) in the RANK column.
6. **SIGN YOUR BALLOT** (the festival cannot continue without all ballots being signed)
7. Place in the envelope, and bring it and your share sheets directly to Tabulations.

You must score in every category for every event

ORDER OF PERFORMANCE	SCHOOL CODE	Judges Notes:	RESEARCH /CONCEPT	SET DESIGN	LIGHTING DESIGN	GRAPHICS DESIGN	OVERALL PRESENTATION	RANK	NOT APPROPRIATE
EX:	WZ20		E	G	E	S	G	3	✓
1									
2									
3									
4									
5									
6									
7									
8									
9									
10									
11									
12									
Judge's Name (print)			Judge Number						
Judge's Signature			Cell Phone Number						

13									
14									
15									
16									
17									
18									
19									
20									
21									
22									
23									
24									
25									
26									
27									
28									
29									
30									
31									
32									
33									
34									
35									
36									
37									
38									
39									
40									
41									
42									
43									
44									
45									



**Drama Teachers Association
of Southern California**

**Sets, Lights, Graphics
Share Sheet**

Event Number

Event Name

Room

Round

1

2

Semi-Finals

School Code

Title

Comments

Please write constructive comments in the space provided. Coaches and students review these forms as a tool for learning.

Multiple empty horizontal lines for writing comments.

Areas of Evaluation

You must mark EVERY category in EVERY performance

Research/Concept

Knowledge of the chosen play and time period. A clearly defined design idea.

Superior

Excellent

Good

Fair

Needs Work

Set Design

Set—Practicality and professionalism of design/model

Superior

Excellent

Good

Fair

Needs Work

Lighting Design

Lighting—Required paperwork, instrument choices, display

Superior

Excellent

Good

Fair

Needs Work

Graphics Design

Graphics- A visual representation of the mood and style of the concept.

Superior

Excellent

Good

Fair

Needs Work

Overall Presentation

Professionalism of presenters, overall preparation, clear speech

Superior

Excellent

Good

Fair

Needs Work

Judge Number

Judge Name

Judge Signature



**Drama Teachers Association
of Southern California**

Graphics Ballot

Event Number

Event Name

Room

Round 1 2 Semi-Finals Finals

Instructions

1. Fill in Event and Room Number and circle the round.
2. Copy the school codes in the order of performance the room chair has listed on the board.
3. Watch the scenes and make comments on the share sheet provided for student feedback.
4. Then assign a letter for the quality in each category. Use the following abbreviations:
S=Superior (Grade=A) **E=Excellent** (Grade =B) **G=Good** (Grade =C) **F=Fair** (Grade =D) **NI=Needs Improvement** (Grade =Fail) **X=No Show**
5. After you have scored all the scenes, rank them from best (1) to worst (45) in the RANK column.
6. **SIGN YOUR BALLOT** (the festival cannot continue without all ballots being signed)
7. Place in the envelope, and bring it and your share sheets directly to Tabulations.

You must score in every category for every event

ORDER OF PERFORMANCE	SCHOOL CODE	Judges Notes:	CONCEPT	PROGRAM DESIGN	GRAPHIC/ POSTER DESIGN	PUBLICITY PLAN	OVERALL PRESENTATION	RANK	NOT APPROPRIATE
EX:	WZ20		E	G	E	S	G	3	✓
1									
2									
3									
4									
5									
6									
7									
8									
9									
10									
11									
12									
Judge's Name (print)			Judge Number						
Judge's Signature			Cell Phone Number						

13									
14									
15									
16									
17									
18									
19									
20									
21									
22									
23									
24									
25									
26									
27									
28									
29									
30									
31									
32									
33									
34									
35									
36									
37									
38									
39									
40									
41									
42									
43									
44									
45									



Graphics Share Sheet

Comments

Please write constructive comments in the space provided. Coaches and students review these forms as a tool for learning.

Multiple empty horizontal lines for writing comments.

Areas of Evaluation

You must mark EVERY category in EVERY performance

Concept

Clarity of connections between choices and the play

Superior

Excellent

Good

Fair

Needs Work

Program Design

Presentation and professionalism of design of a 4 page program

Superior

Excellent

Good

Fair

Needs Work

Graphic/Poster Design

Color choices, appropriateness, and overall display

Superior

Excellent

Good

Fair

Needs Work

Publicity Plan

Clear timeline, best value, explanation of audience outreach

Superior

Excellent

Good

Fair

Needs Work

Overall Presentation

Professionalism of presenters, overall preparation, clear speech

Superior

Excellent

Good

Fair

Needs Work

Judge Number

Judge Name

Judge Signature

TABULATIONS KEY (THE LAST WORD)

SPOILER ALERT... better not to know.

Tech – All Divisions

Schools are ranked 1 to 10, 1 being the best. Anything above 10 is ranked as 15. No shows are ranked as 999. Judges' scores are averaged to produce final placement.

Divisions B and C
Rounds 1 and 2

Each judge rates each entry in 5 areas (see share sheets for specific areas). Round one is tabulated (if more than one judge, the score is averaged). Round two is tabulated (if more than one judge, the score is averaged). Round one and round two scores are averaged to give a score for semi final advancement. Reminder: lowest scores advance.

Ratings receive the following point value (view your ratings on the event tab sheets):

- Superior – 1
- Excellent – 2
- Good – 3
- Fair – 4
- Needs Improvement – 5

*No Show – Total round score 495

Based upon the total number of entries in each category, a percentage is determined for advancement to semi finals.

Semi-finals and Finals

The scores are based on ranking from 1st to however many are in the room (1st being the best). The scores are entered into the computer. Anything 7th place or higher is recorded as 7th for the sake of fairness. The judge rankings are averaged to advance entries to final rounds or to produce trophy winners. Based on total number of entries, the top from each room advance to finals.

Division A

The scores are based on ranking from 1st to however many are in the room (1st being the best). The scores are entered into the computer. Anything 7th place or higher is recorded as 7th for the sake of fairness. The judge rankings from round 1 and round 2 are averaged to place entries into round 3. The top 6 plus ties are placed into one room (the trophy room). The remaining entries are power ranked into the other rooms competing for honorable mentions.

continued

TABULATIONS KEY, CONTINUED

SWEEPSTAKES DIVISION B & C

Rounds 1 and 2

Score	Sweepstakes Points		
	Monologue	5 min scene	8 min scene
5 - 8	3	4	5
8.01 - 12	2	3	4
12.01 - 15	1	2	3

Semi-Finals

Placement in room	Sweepstakes Points		
	Monologue	5 min scene	8 min scene
1st	7	8	9
2nd	6	7	8
3rd	5	6	7

Finals

Placement in room	Sweepstakes Points		
	Monologue	5 min scene / Tech	8 min scene
1st	9	11	13
2nd	8	10	12
3rd	7	9	11
4th	6	8	10
5th	5	7	9
HM	2	3	4

** note: Tech category receives 1 point for entering

SWEEPSTAKES DIVISION A

Rounds 1 and 2

Placement in room	Sweepstakes Points		
	Monologue	5 min scene	8 min scene
1 st	3	4	5
2 nd	2	3	4
3 rd	1	2	3

Round 3 (Trophy Room)

Placement in room	Sweepstakes Points		
	Monologue	5 min scene / Tech	8 min scene
1 st	9	11	13
2 nd	8	10	12
3 rd	7	9	11
4 th	6	8	10
5 th	5	7	9

** note: Tech category receives 1 point for entering

REMEMBER — It's just a festival...

DTASC Computer Manual

Non-member Login instructions:

- Open your web browser to www.dtasc.org or www.cetoweb.org/dtasc_pages
- Go to registration page
- Click link next to “Not a Member?”
- Fill out all required fields
- Press submit
- Allow 3-5 business days for the membership secretary to update your profile
- Then follow member instructions

Member Login Instructions:

- Open your web browser to www.dtasc.org or www.cetoweb.org/dtasc_pages
- Go to registration page
- If you have forgotten your login information, press the link next to “Forgot your Password?”
 - Type in your *username* and press submit
 - An e-mail will be sent with your login information
- In the login field type in your *username*
 - Original usernames were created as follows: first initial last name
Example- John Doe = jdoe
- In the password field type in your *password*
 - Original passwords were school name without “high school”
Example- Urinetown High School = urinetown
Bedrock Middle School = bedrock
Little Valley School = littlevalley
- Press submit

continued

General User Homepage

Verify that your school name is at the top of the page

At any point, clicking on the word “Home” located on the left side of the screen, will take you back to this page.

PLEASE MAKE SURE THAT WE HAVE YOUR CURRENT INFORMATION

“Change Contact Information” Button

- To change/update your contact information, click here and update fields
- Click Update button

“Change Password” Button

- To change your login password, click here and complete fields
- Click “Change the Password”

“I Changed School/Not Teaching Anymore” Button

- If you changed school or are not teaching anymore, please click here and follow instructions

Registration

- Click the appropriate division button
 - A- grades 6,7,8
 - B- grades 8,9
 - C- grades 9,10,11,12
- Registration page will load
- Select number of participants for each event
- Select and ad size and price (minimum \$15)
 - If entering both Division A and B, to only purchase one ad, select the appropriate size and price for the first divisional sign up. Then on the subsequent registration, select the “Have one in...” drop down
- Type in the additional programs desired
- Type in the number of coach lunches desired
- Select number of memberships from the drop down menu
- Check the main membership if applicable
- Fill out the membership information textbox as instructed
- To update the total amount due at the bottom of the page, at this time click “Add Additional Fees to Total” button
- Select the number of room chairs
- In Division A, type in the number of supervisors
- Type in the number of non-participating student directors
- **VERIFY THAT ALL INFORMATION IS CORRECT, once submitted, registration may not be changed!**

continued

DTASC COMPUTER MANUAL FOR CD

- Press submit
- Back at the Home Page, click on corresponding View Registration buttons and print out registration information for both hard copy registration and for your records
- Mail in hard copy registration and check to appropriate registrar whose information is located on the bottom of the Home Page

Membership Secretary

- Login

“Change Contact Information” Button

- To change/update your contact information, click here and update fields
- Click Update button

“Change Password” Button

- To change your login password, click here and complete fields
- Click “Change the Password”

“Meeting Attendance” Button – used to mark attendance at the mandatory meeting, allowing member to register for current festival

- All members will be listed under “Did not attend” automatically before each mandatory meeting
- Scroll down the list clicking the arrow button to mark members in attendance
 - Note- page will refresh after each click
- In the event of a mistake, click the left pointing arrow to move the member to the did not attend list

“Add a new school” Button – used to link new member account to school information (e-mail notification is sent to the membership secretary when a new account is created and that e-mail is notification to follow the process below)

- A list of schools will appear
- For each school, click the “assign school code” button
- A new page will load with a closest matching list of currently active schools
 - If the school is a match to one of the listed schools, click “Assign login to this school” button
 - If the school does not match, press the “Full school list please” button
 - Note – some schools are not listed by their first name (i.e. Orville Wright MS could be listed as Wright MS)
- If you’ve selected “Full school list please” button, a list of every active school will display

continued

DTASC COMPUTER MANUAL FOR CD

- If the school is a match to one of the listed schools, click “Assign login to this school” button
- If there is no match, click the “Add New School ID” button which is located at the bottom of the page

Registrars

- Login

“Change Contact Information” Button

- To change/update your contact information, click here and update fields
- Click Update button

“Change Password” Button

- To change your login password, click here and complete fields
- Click “Change the Password”

“Change mailing addresses” Button

- To change or update the registrars’ mailing addresses, click here and complete fields
- Click “update” button

“New Festival” Button

- Type in the next festival categories
- Following instructions, indicate what the PREVIOUS festival was
 - Click either Fall or Shakespeare
 - In the text box provided, type the previous festival’s year (i.e, 2006)
- Press the “Reset for New Festival” Button

Check received buttons

- Click appropriate divisional button
- A list of schools that have registered but not paid will appear
- Click “Payment Received in Full” button if check matches amount
 - School name will disappear
- If authorized by the DTASC President, click “Marked Paid” button to allow a school to participate without payment
- To automatically e-mail all school on the list with a payment due reminder, click “E-mail all Schools a reminder”

Division A/B Buttons

“Create Div. A/B Program”

- A list of events for each division will appear
- Next to each event title are the current entry totals

continued

DTASC COMPUTER MANUAL FOR CD

- Select the number of rooms needed per event from the drop down list box
 - Note- the page will refresh after each selection
 - Recommendation – select number of rooms for all events before continuing
- In the text boxes provided, type in the room names/numbers for each event
- Double check that the number of rooms and the number of text boxes filled out match and that the room names/numbers start in text box labeled 1.
- Press “Submit” button and wait

“Print out Schools Lists” Button – produces a printable page with codes alphabetized separately by code and school

“Print Out A/B Program” Button – produces a page formatted correctly with the information for the program

“Print out Festival Info” Button – produces a page with school registration totals

Division C Buttons

“Create Div. C Program”

- A list of events will appear
- Next to each event title are the current entry totals
- Select the number of rooms needed per event from the drop down list box
 - Note- the page will refresh after each selection
 - Recommendation – select number of rooms for all events before continuing
- In the text boxes provided, type in the room names/numbers for each event

“Print out Schools Lists” Button – produces a printable page with codes alphabetized separately by code and school

“Print Out C Program” Button – produces a page formatted correctly with the information for the program

“Print out Festival Info” Button – produces a page with school registration totals

Post Festival Information:

“Attendee Address list” Button – produces a page with instructions and data on how to create labels for all schools that attended the current festival

President

“Change Password” Button VERY IMPORTANT

continued

DTASC COMPUTER MANUAL FOR CD

- To change your login password, click here and complete fields
- Click “Change the Password”

“Presidential Edit of Database” Button

- For all pages with information:
 - On the right hand side will be the word “Edit”
 - ⊙ Clicking this word will allow you to edit one line of the database
 - ⊙ Make necessary changes
 - ⊙ Click the word Update which replaced the word “Edit” to update the database
 - ⊙ Click the word cancel which replaced the word “Edit” to abort changes
 - On the right hand side will be the word “Delete”
 - ⊙ Clicking this word will WITHOUT VERIFICATION remove that line of the database
- This page gives you two options
- “Registration D/B” gives you the registration options
 - “Login Information” Button produces a page with Members’ logins and passwords
 - “School Registration” Button produces a page with all registration information per school
 - “User Information” Button produces a page with member contact information per person
 - “Event Names” Button produces a page with the current event titles
 - “First Place Winners” Button produces a page with the first place winners
- “Tabulations D/B” gives you the tabulations options broken down by division
 - Example, to edit a score given in Division B, Event 4 – press the IV button located under Division B

Tabs

- To login to Tabs, go to www.cetoweb.org/dtasc_pages/festival/loginTabs.aspx
- This may change as the tri-website develops

Login

Choose Round One or Round Two

- Select the number of judges for the room that is being entered
- Click the “Enter the Values” button for that room
- Verify that you are on the page for the room and the judge number
- Enter the values
- Click “Submit”
- The program will display the verification page

continued

DTASC COMPUTER MANUAL FOR CD

- Verify that all scores have been entered correctly
- If there is an error, click "Redo all entries"
- If the information is correct, click "Submit"
- The program will take you back to the main page of the round on which you are working
- Repeat for all rooms
- Select "Main Menu" on left to move between Round One and Round Two
- Once Round One and Round Two are completed, for Division A press "Move to Round Three" Button. For Division B and C, press "Move to Semi-Finals" Button

For Division A Round Three- page will display listing the total number of entries for that event.

- Select the number of Round Three rooms and enter room numbers.
- Press "Submit"

For Division B and C Semi-Finals- page will display listing the total number of entries in six possible percentage choices.

- Select the appropriate one. PERCENTAGE MUST BE APPROVED BY THE HEAD OF TABULATIONS. Select the number of Semi-Finals rooms and enter room numbers.
- Press "Submit."

For all divisions, the "Resort" Button is available for the Audition Event ONLY. This is used to manually switch rooms to avoid two school entries in the same room.

"Print Out" displays a page of codes for current round.

Enter the information the same as Round One and Round Two.

For Round Three, press "Complete the Category"

For Semi-Finals, move to Finals. Type in the room for Finals. Click "Submit"

Finals is the same as Sem-Finals, but you cannot resort.

- Enter the information
- Press "Complete the Category"
- Final Page gives you two options. "Print Finals results" displays the winner page. "Print out all Rounds" displays the scores and rankings for all rounds.

Tech

Login

Select specific "Tech Event"

continued

DTASC COMPUTER MANUAL FOR CD

- Select the number of judges for the room that is being entered
- Click the “Enter the Values” button for that room
- Verify that you are on the page for the room and the judge number
- Enter the values
- Click “Submit”
- The program will display the verification page
- Verify that all scores have been entered correctly
- If there is an error, click ”Redo all entries”
- If the information is correct, click “Submit”
- The program will take you back to the main page of the round on which you are working
- Press “Complete the Category”
- The selection page will be displayed
- Complete all tech events
- Press “And the Winners Are” Button
- Final Page gives you two options. “Print Finals results” displays the winner page. “Print out all Rounds” displays the scores and rankings for all rounds.

Sweeps

Login

- A selection page is displayed
- “The Winners Are” Button displays the Winner page
- “Sweeps Info Chart” displays a spreadsheet of sweepstakes points
- “Best in Show” displays the top five average point winners

ERROR MESSAGE SCREEN

If you get an error screen with a lot of strange characters, usually on a beige background,

Quit Internet Explorer

Re-launch Internet Explorer

Sign back on to DTASC

If you get a sign-in box on the left instead of center, go to the address bar at the top and see if it reads: www.cetoweb.org/dtasc_pages/festival/login.aspx

Click in between login and the dot, and type Tabs (with a capital T) so the address line reads: www.cetoweb.org/dtasc_pages/festival/loginTabs.aspx

Then click Go or hit Return or Enter and you will be back to the Tabs sign-in.



*Drama Teachers' Association
of
Southern California*

has fulfilled _____ hours of

COMMUNITY SERVICE

for 1 I.T.S. Point

preparing for the

*DTASC
Fall Drama Festival*

On _____

DTASC President

Coach



*Drama Teachers' Association
of
Southern California*

has fulfilled 10 hours
of
COMMUNITY SERVICE

for 1 I.T.S. Point

at the

*DTASC
Shakespeare Festival*

Held on _____

DTASC President

Coach



*Drama Teachers' Association
of
Southern California*

Recognizes

For participating in the

_____ *Annual*
Fall Drama Festival

Held on the _____ *day* of _____

in the year *Two Thousand* _____

DTASC President

Coach



*Drama Teachers' Association
of
Southern California*

Recognizes

For participating in the

_____ *Annual*
Shakespeare Festival

Held on the _____ *day* of _____

in the year *Two Thousand* _____

DTASC President

Coach

DTASC Membership Information

Mail with a check made out to DTASC for \$30.00 for school membership, and mail it or pay at the Fall Business meeting on or before Nov. 1 or

you can include your current year's membership with your Fall festival registration.

Remember, that any teacher who directs festival students must be a current paid DTASC member.

Please register any additional teachers who direct your students on another member form and submit with \$20.00 membership dues.

*******If you are a current paid member of CETA and EdTA(CA Thespians) and DTASC for the same year, you can receive a \$15.00 DTASC voucher as a reward for tri-membership to be used for DTASC merchandise before June 30, 09.**

Print all information.

TEACHER'S NAME _____
SCHOOL _____
SCHOOL ADDRESS _____
SCHOOL CITY _____ ZIP _____

SCHOOL PHONE() _____ EXT _____ SCHOOL FAX() _____
School Email-Give only if you can access your email during vacations. Print one symbol/letter per line

HOME ADDRESS _____
HOME CITY _____ ZIP _____

HOME PHONE () _____ HOME FAX () _____

PERSONAL EMAIL (Print each symbol clearly-one symbol/letter/number per line.)

CELL PHONE (for contact during festival day/s by DTASC officers)
() _____

----- Tear off the bottom part as a reminder. -----
You will not be considered a member until your membership dues are paid.

Membership extends from October to September 1
Membership Classifications

Active=teacher of Theatre in SO. CA secondary schools-1 member per school; voting rights; festival participation with students; \$30.00 yearly dues-Each person from a school who directs students must join. \$20.00 for each additional member.

Associate=company/individual that supports the DTASC mission; no voting or competition rights; \$70.00 yearly dues; catalogues/materials will be distributed to DTASC members.

Emeritus=non-teaching individuals who have rendered conspicuous service within DTASC; no competition participation; voting rights; no yearly dues.

Mail to Gai Jones, 1410 White Oak Circle, Ojai, CA 93023

ASSOCIATE DTASC MEMBER FORM

For Sept. 1, _____ -Sept. 1, _____

An Associate Member is a company or individual that supports the DTASC mission statement:

It is our mission to create a network where theatre educators and students can effectively communicate ideas, share resources, workshops, and show-cast their theatre skills. We believe in creating an environment that fosters the best in educational theatre through performance opportunities, diversity, and professional adjudication. We support and reward hard work, and commitment to the discipline of theatre and education.

The cost for Associate membership is \$70.00 to be paid annually on or before the Fall business membership meeting. There is a maximum of one Associate member for each company. Membership extends from September 1 to September 1.

For the term of year paid membership the following offers will be available:

- An associate company representative may make a brief presentation to DTASC members at the Fall and Winter annual meetings;
- An associate company may set up a table and distribute information to DTASC members at the Fall and Winter meetings;
- An associate company may set up a complimentary table at four student festivals throughout the academic year and distribute information to participating students;
- An associate company may purchase ads for the Fall and Spring Festival booklets;
- An associate company may have a link on the DTASC website;
- An associate company's representative may judge at the annual DTASC scholarship auditions;
- An associate company representative will receive a member booklet with DTASC school addresses;
- An associate company's flyers/catalogues will be distributed to new DTASC members throughout the yearly of current associate membership.

Print all information and submit with a \$50 check made to DTASC before Sept. 9.

Company/Individual name _____

Contact Person's name _____

Address _____

City _____ Zip _____

Phone () _____ Fax () _____

Email (Print each symbol clearly-one symbol/letter/number per line.) _____

Mail to Gai Jones, 1410 White Oak Circle, Ojai, CA 93023 on or before Sept. 9.

DTASC-JUDGE SUBMISSIONS

Each DTASC coach is required to submit a minimum of 3 qualified judges for the upcoming festival. Submit by e-mail to gaijones@ix.netcom.com. Put "DTASC Judge Submission" on the Subject Line of the e-mail. Or Fax to 805 640-6472 * 51

Or mail to Gai Jones, 1410 White Oak Circle, Ojai, CA 93023.

Or go to dtasc.org, find Forms – Judges, and fill out the form online. Click Submit when done. Submit no later than Feb. 14.

Division C: Judges must be at least 4 years out of high school.

Division B: High school seniors may judge if their school is not entered in that event.

Division A: High school seniors may judge.

Desirable Qualities for every Judge

- Must be able to write constructive comments; ones which are suitable for the mother of student, who is 10-18 years of age;
- Must have readable handwriting;
- Must be able to COMPLETE every aspect of the Share Sheet and circle required ratings;
- Must be able to complete a Judged ballot completely;
- Must understand if the judge gives a GOOD or FAIR, the comments must include constructive critiques to justify the GOOD/FAIR rating;
- Must stay awake during the performances;
- Must change rooms if the Judge knows any performer in the room;
- Must be able to sign ballots by printing and signing name;
- Must be able to list NO SHOW on a non performing Share Sheet;
- Must be able to judge on the age appropriate performance.

Please list the correct/up-to-date Contact Information for Submissions.

1. Name _____
2. Address _____
3. City _____ Zip _____
4. Phone () _____
5. E-mail _____
6. Qualifications _____

1. Name _____
2. Address _____
3. City _____ Zip _____
4. Phone () _____
5. E-mail _____
6. Qualifications _____

1. Name _____
2. Address _____
3. City _____ Zip _____
4. Phone () _____
5. E-mail _____
6. Qualifications _____

PROPOSED RULES CHANGES FORM

REMINDER: As of June 2008, rules changes will be considered only in even numbered years, although Board members can propose emergency changes in off years if necessary.

IMPORTANT: All proposed rules changes at our June meeting must be submitted to the Rules Committee PRIOR to the meeting.

Deadline is May 15th.

Mail to: Susan Eiden
13562 E. Starbuck St.
Whittier, CA 90605

Or e-mail: SusanEiden@aol.com

Your name:

Proposed rule change:

Comments:

EVENT SUGGESTIONS

Event Suggestions need to be emailed to the following by the 2nd Friday of May:

Division C Vice President

Division A/B Vice President

(see Board list on page A2-1 for email addresses, A3 for snail mail addresses)

Include whether the scene is for 2–4 persons (5 minute scene), 3–10 persons (8 minutes), or 3–6 persons (8 minutes), and any other pertinent information. One event at each festival must be designated a Straight Scene.

Events for the following year are voted on at the June business meeting.

Fall Festival (year) _____

Shakespeare (year) _____

DTASC Form – Nomination of Officers Spring _____

I _____ nominate the following members
in the following offices:

PRESIDENT _____

EXECUTIVE VICE PRESIDENT _____

DIVISION C VICE PRESIDENT _____

DIVISION A/B VICE PRESIDENT _____

TREASURER _____

RECORDING SECRETARY _____

DIVISION C REGISTRAR _____

DIVISION A/B REGISTRAR _____

MEMBERSHIP SECRETARY _____

Please mail/give your nomination form to the Chair of Elections by the end of A/B Shakespeare Festival in any even-numbered year.

You will receive a ballot in May that will need to be returned by the 1st of June.

FYI, the following offices are appointed by the DTASC Board:
Historian, Parliamentarian, Chair of Tabulations, Chair of Rules, Chair of Judges

ROOM CHANGE NOTICE

EVENT _____

ROUND _____

HAS MOVED TO

ROOM _____



The Drama Teachers Association of Southern California

SAMPLE LETTER FROM VICE PRESIDENT TO ADMINISTRATOR OF PARTICIPATING SCHOOL

November 7, 2000

Dear Administrator:

Congratulations on your talented students and your devoted theatre educator. Theatre develops in students the self-confidence, spirit of cooperation, self-discipline, self-motivation and imagination necessary to succeed in life. Theatre also develops a respect for ethnic and cultural diversity. Your theatre students and their theatre educator spent Saturday November 4, 2000 participating in the Fifty-ninth annual Drama Teachers' Association of Southern California Theatre Festival at Palos Verdes Peninsula High School.

Over 800 students and their directors gathered for two compulsory rounds in Technical Theatre Design, Audition Monologue, all female scene, contemporary scene, musical scene, Oscar- winning screenplay, drama and humorous scene. Professionals in the theatre industry adjudicated each student. Based on their performances, students progressed to semi-finals or to a finals round.

All first place scenes were invited to represent DTASC to perform at a "Salute to the Winners" on November 8 at the Ivar Theatre in Hollywood.

Past DTASC winners include Kevin Spacey, Mare Winningham, Cuba Gooding Jr., Sally Fields, and Nicholas Cage.

Thank you for supporting the ARTS in Education.

Congratulations!

Sincerely

CI Foss
Vice-president, DTASC

Drama Teacher's Association of Southern California

17888 Haynes Street
Van Nuys, CA 91316

November 12, 1998

Dear Administrator,

Congratulations on your wonderful students and your dedicated theatre educator! They spent a SATURDAY to help their students develop in the art of Theatre by participating in the annual Drama Teacher's Association of Southern California Fall festival.

1,600 students and their directors gathered for two compulsory rounds in Technical Theater Design, Audition Monologue, Small Group Comedy, Small Group Drama, Musical Theme Collage, Large Group Comedy, Large Group Drama, and Improvisation. Each student was adjudicated by professionals in the theatre industry. Based on their performances, students progressed to semi-finals, and then to a finals round.

Mare Winningham, past DTASC winner, Emmy winner, and Academy Awards nominee congratulated all participants and presented the trophies to the Monologue category. Other past DTASC winners include Cuba Gooding Jr., Kevin Spacey, and Nicholas Cage.

All finalists are invited to represent DTASC on March 11, 1999 to perform at California Educational Theatre Association conference in Sacramento, "in Celebration of Theatre Education an the Future of California: Its Youth." A reception with performers and legislators will be held following the performances. The students and their teacher will have the opportunity to talk with their local legislator about the excellent programs at your school. Administrators representing schools in the final rounds may also accompany and participate in this celebration and take advantage of the statewide recognition of your school's outstanding theatre program. Your theatre teacher will need assistance in arranging financial support for the conference, perhaps from your school board, booster club, or special funding sources.

Thank you for supporting the ARTS in Education.

Congratulations!

Sincerely,

C.J. Foss
Vice-president, DTASC

SAMPLE THANK YOU LETTER TO FESTIVAL HOST

To Robert Arnold and Sun Valley Middle School:

March 21, 2000

On behalf of the Drama Teachers Association of Southern California, we would like to express our thanks to you for hosting the annual Div, A,/B DTASC Shakespeare Festival. Thanks to you and your supportive administration, faculty and parents, the competition was a great success.

Your campus really sparkled. Thank you also to all of the custodial workers, the leadership students, the supervisors and the officers. It was especially exciting to have two guest speakers along with your cluster leader to welcome the competitors. The support was overwhelming.

The students, parents, and coaches were all thrilled with the events of the day.

DTASC continues to survive because of generous and productive people like you.

Thank you again.

Sincerely,

Amanda Swann, DTASC President

SAMPLE THANK YOU LETTER FOR “SALUTE TO THE WINNERS”

May 15, 2002

Jack Nakano and The California Youth Theatre,

On behalf of the Drama Teachers’ Association of Southern California, I wanted to thank you for all that you do for our organization. The Salute to the winners held on April 29th was an exciting and celebratory event for the performers, their coaches, families and friends. Thank you for providing these young people with a beautiful facility, the California Youth Theatre’s Ivar Theatre, and an evening of special memories.

Thank you also for providing the celebrity presenters. Please thank them for us. What an exciting evening!

Thanks again to you and all of the staff at the California Youth Theatre for a magical event.

With great appreciation,

Amanda Swann
DTASC President

Why Teach Theatre In Our Schools

Why teach theatre in our schools

Theatre is a science

Theatre is mathematical

Theatre is a foreign language

Theatre is history

Theatre is physical education

Theatre is language arts

Theatre is art

Theatre is business

Theatre is technology

Theatre is economics

Theatre is taught in schools

Not because one is expected to major in theatre

Not because one is expected to perform all through life,

Not so one can relax,

Not so one can have fun,

But

So one will recognize beauty,

So one will be sensitive,

So one will be closer to an infinite beyond this world,

So one will have more love,

More compassion,

More gentleness,

More good,

In short,

More life

Of what value will it be to make a prosperous living

Unless you know how to live?

That is why theatre is taught in our schools

Adapted with permission from Music Educators National Conference MIOSM Planning Guide

There's No Data like Show Data

There's no data like show data like no data we know
Everything about it is revealing, everything the research shows
is how
Drama gives the kids that happy feeling, when they are steal-
ing that extra bow.

There's no magic like show magic, to raise scores that are low
Even for a class that has the greatest need, research shows
drama helps them read--keep
Acting out those stories 'cause it's what they need, let's go on
with the show!

There's no teaching like show teaching and stats say that it's so
Getting kids engaged can be so thrilling, getting them to act, to
sing, to dance
Smiling as you watch the classroom filling, with students will-
ing, to take a chance.

There's no students like show students, they smile when they
are low
Yesterday they said your kids would not get far., then drama
taught them and there they are
Teaching drama helped the kids to raise that bar, let's go on
with the show!

Let's go on with the show!

Source: Drama Data-Rama, Perpich Center For Arts Education

CAMPUS MAP OF AVIARA OAKS MIDDLE & ELEMENTARY SCHOOLS, CARLSBAD

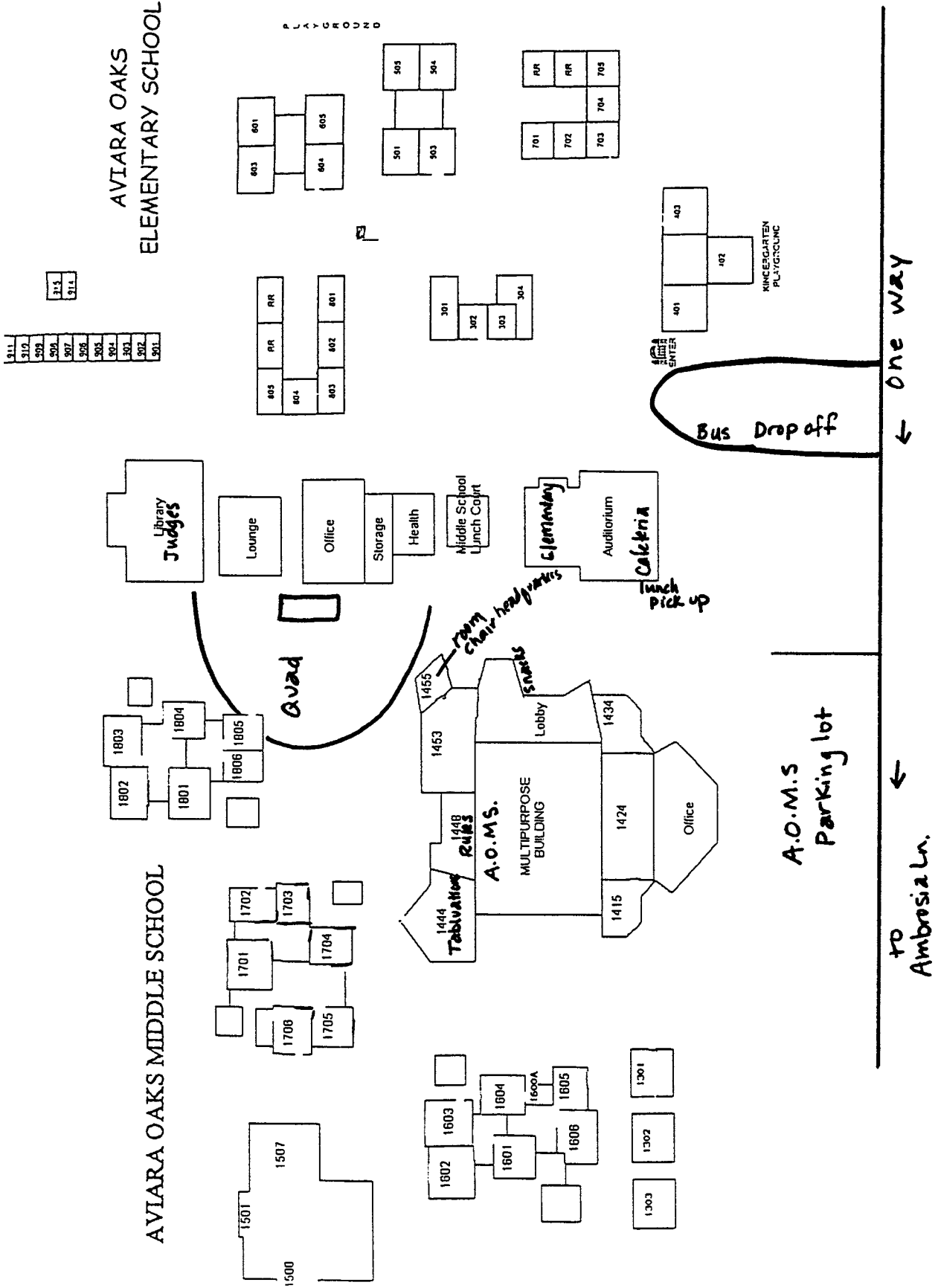

CAMPUS MAP OF BIRMINGHAM HIGH SCHOOL, VAN NUYS

Birmingham High School

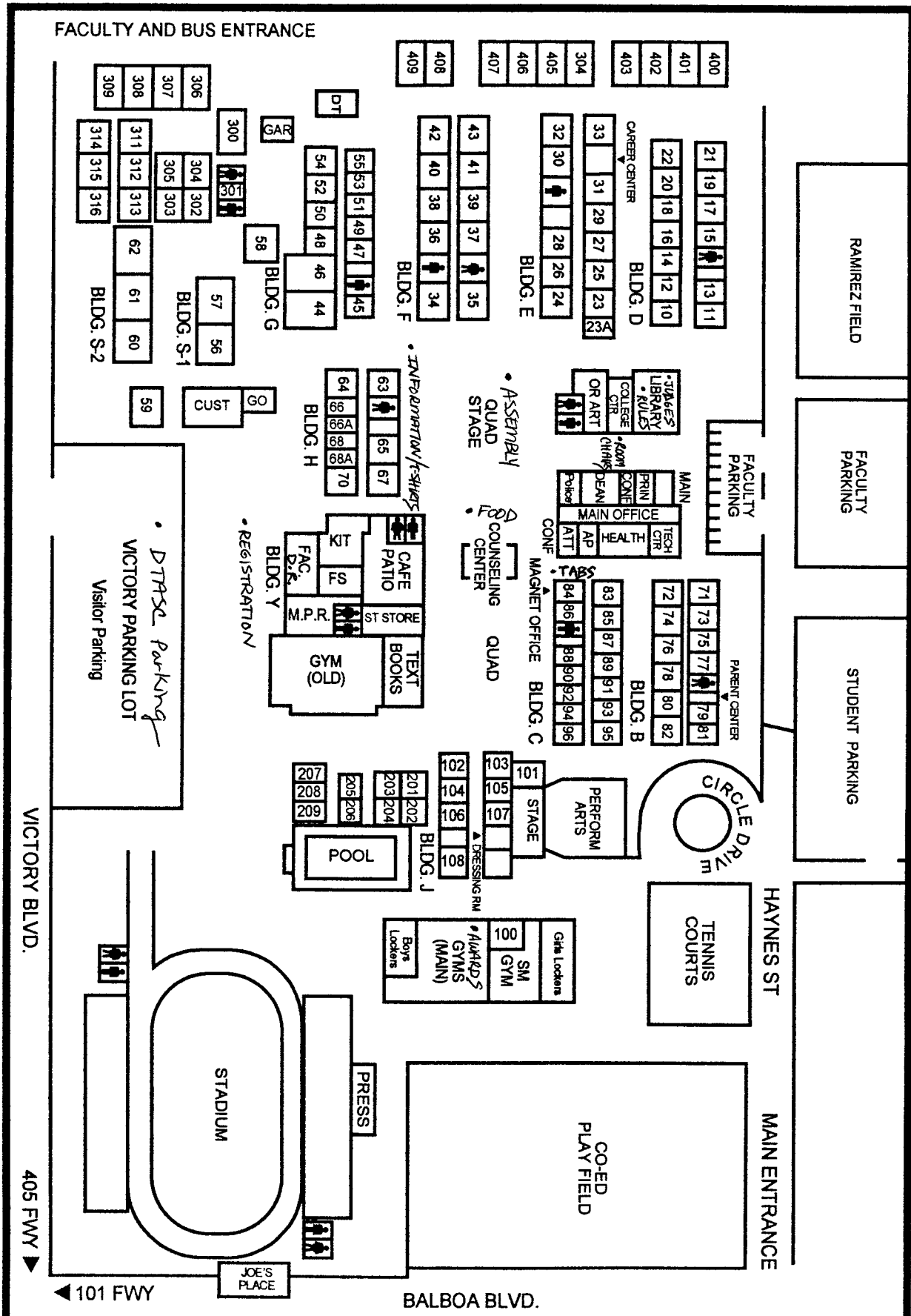

CAMPUS MAP OF CALABASAS HIGH SCHOOL, CALABASAS

Calabasas High School
 22855 Mulholland Hwy
 Calabasas, CA 91302
 (818) 222-7177
 Principal
 CJ Foss

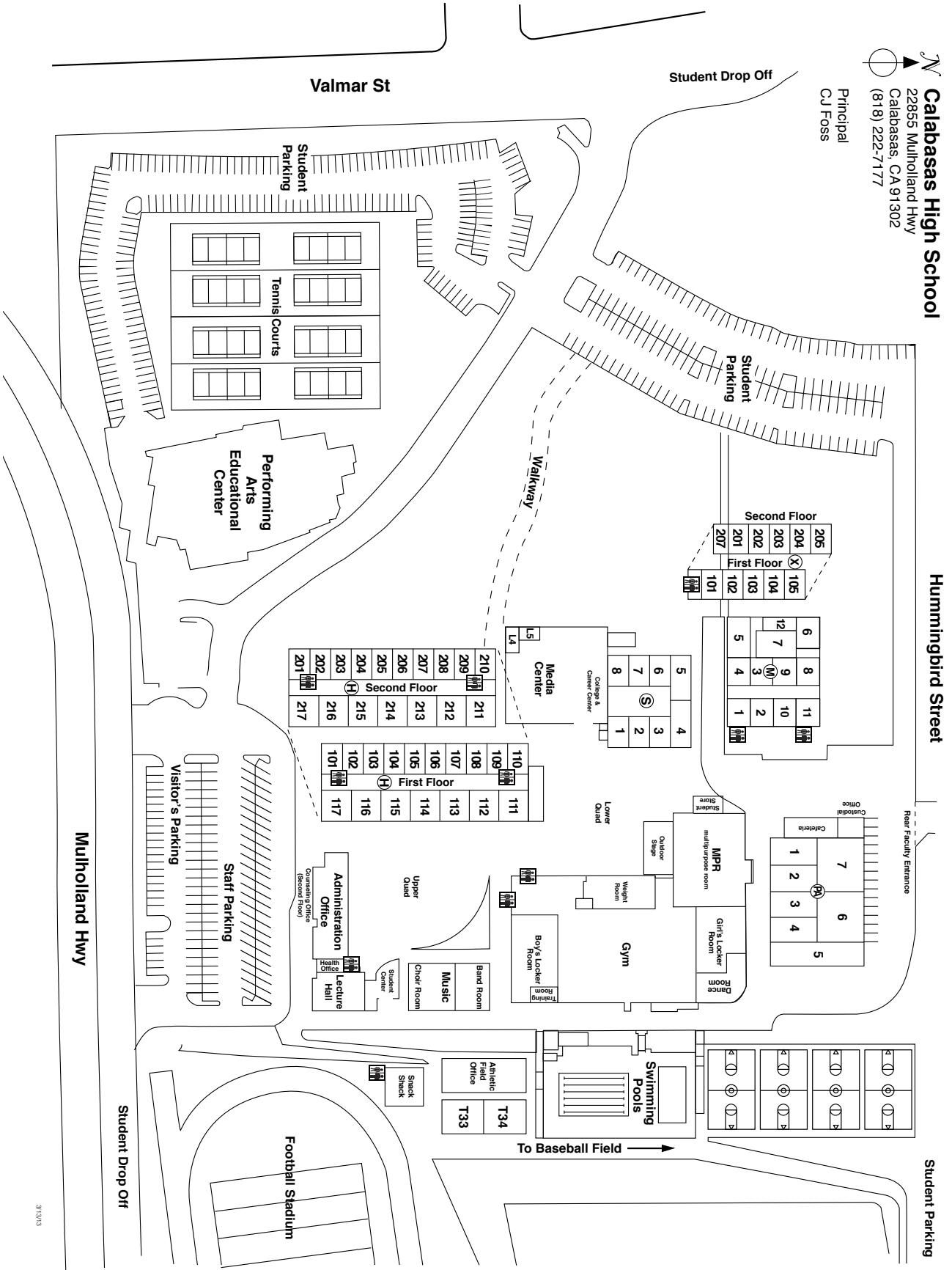

3/13/13

CALIFORNIA HIGH SCHOOL

9800 S. MILLS AVENUE WHITTIER, CALIFORNIA 90604

(562) 698 - 8121 EXTENSION 3000

LEGEND

- G - GIRL'S REST ROOM
- B - BOY'S REST ROOM
- F - FACULTY REST ROOM
- S - STORAGE
- O - OFFICE

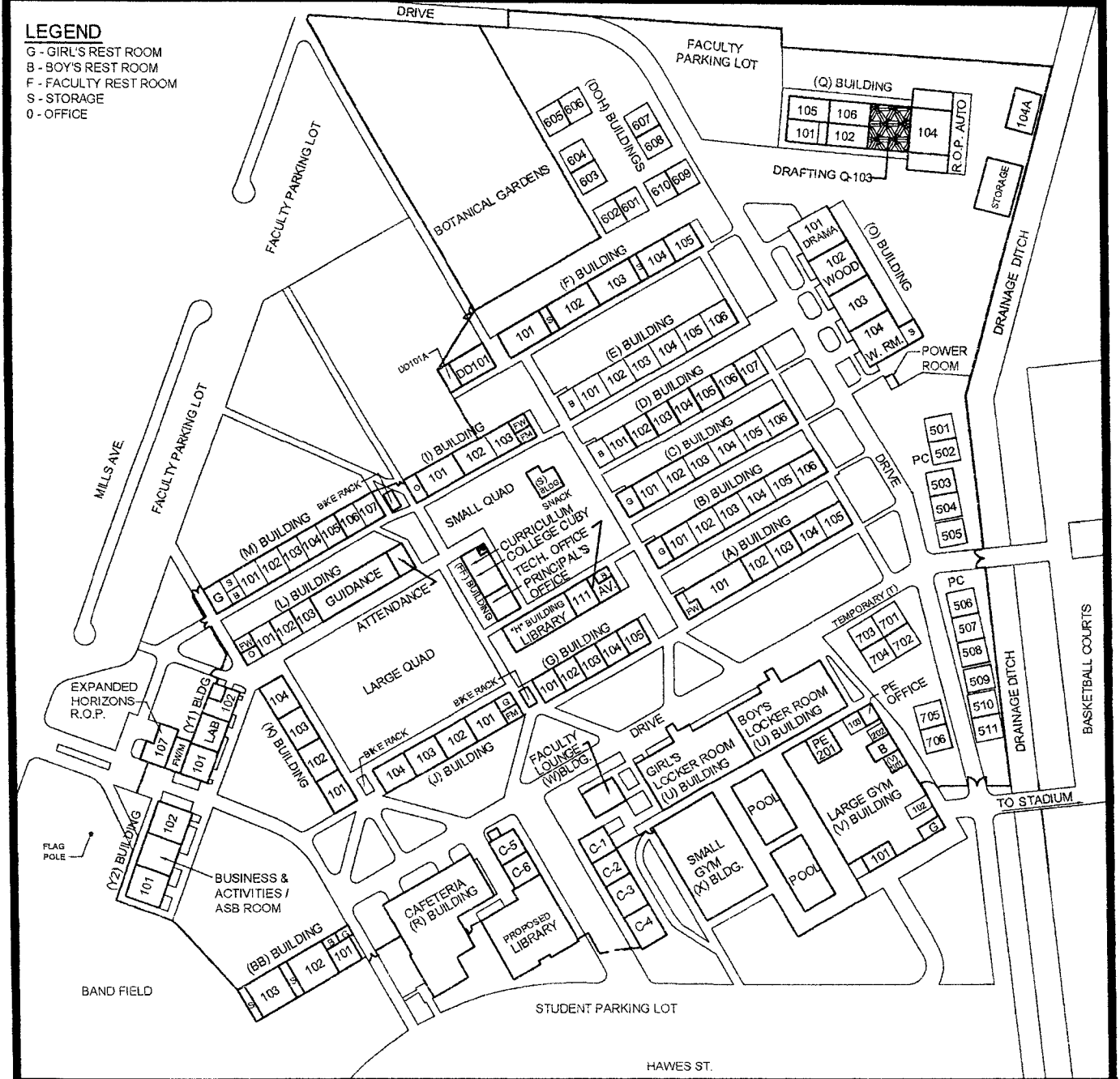

DR. BY ARTHUR RODRIGUEZ 2/19/97

REVISED BY J. HILLS 2/18/00

N. BENSON 9/20/00

A. PEREZ 2/6/05

REVISED BY MR. ALVAREZ 8/28/06

CAMPUS MAP OF CHATSWORTH HIGH SCHOOL, CHATSWORTH

Chatsworth High School
LEMARSH ST

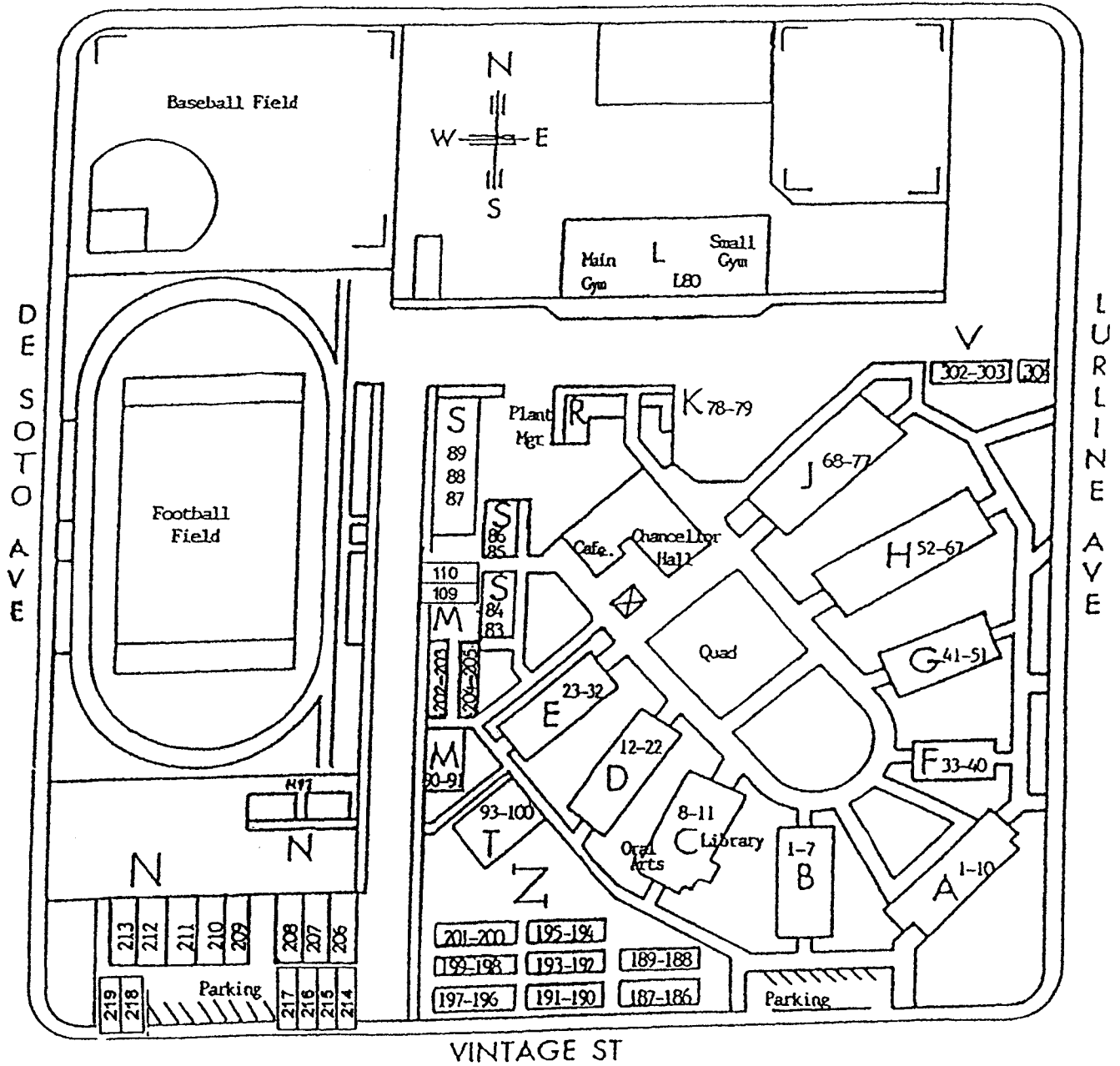

Citrus Hill High School

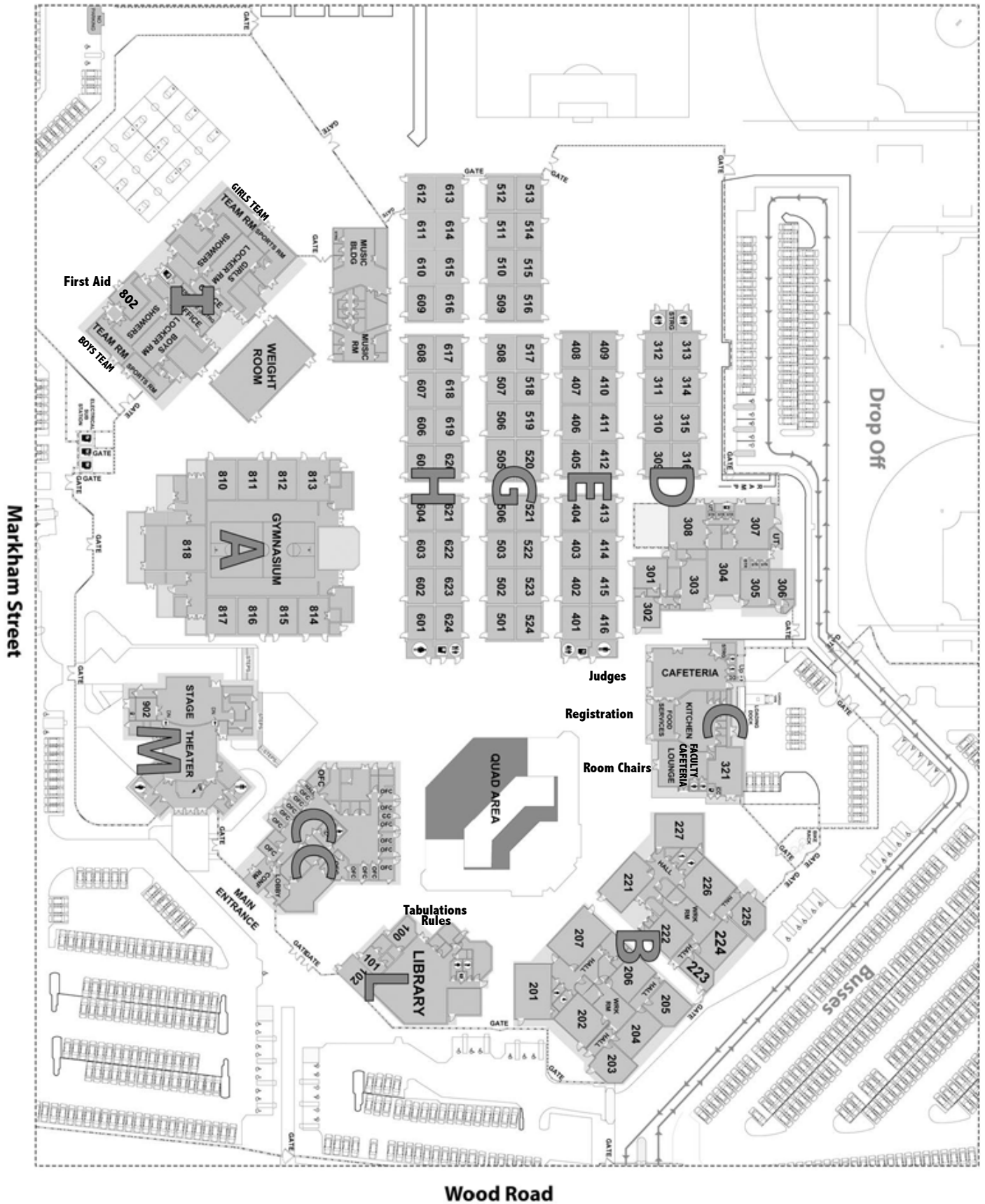

CAMPUS MAP OF COLONY HIGH SCHOOL, ONTARIO

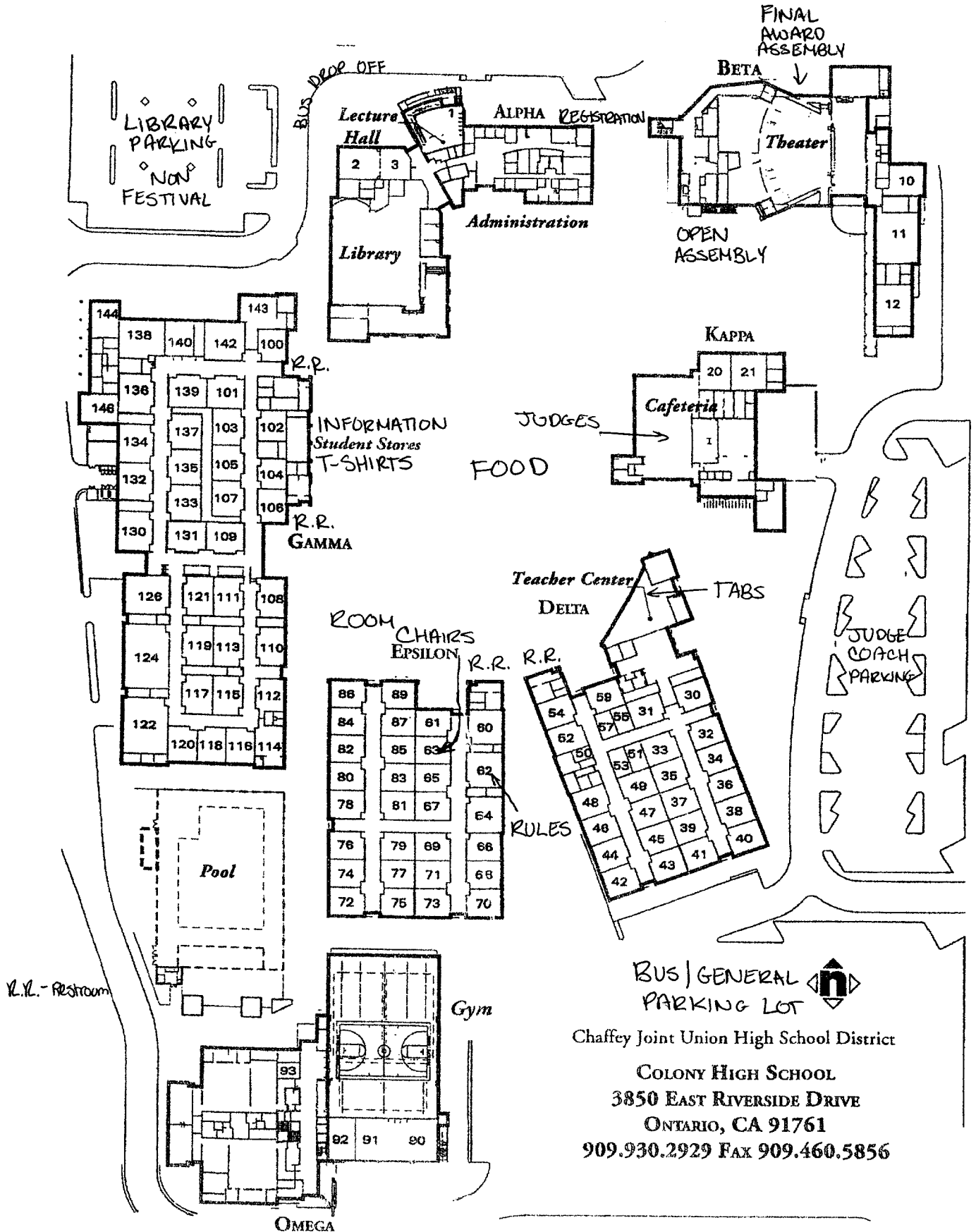

CAMPUS MAP OF FULLERTON UNION HIGH SCHOOL, FULLERTON

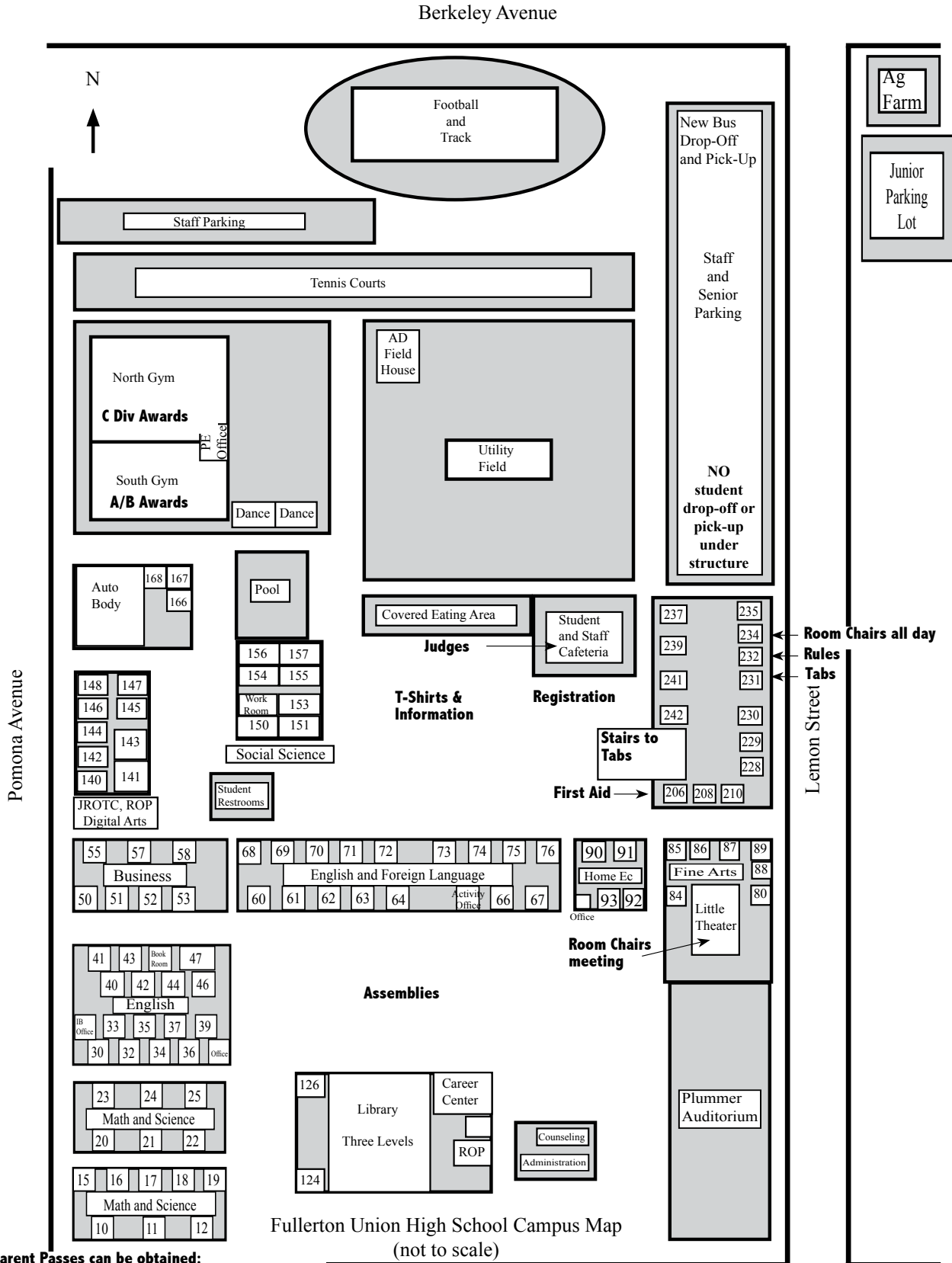

Parent Passes can be obtained:
 • before Round 1 — at Registration
 • rest of day — at Information/T-shirt Table

Room changes for C Div Event 2:
 Program says 19 - go to 22.
 Program says 25 - go to 62.

JOHN BURROUGHS HIGH SCHOOL

MAP and EMERGENCY PLAN

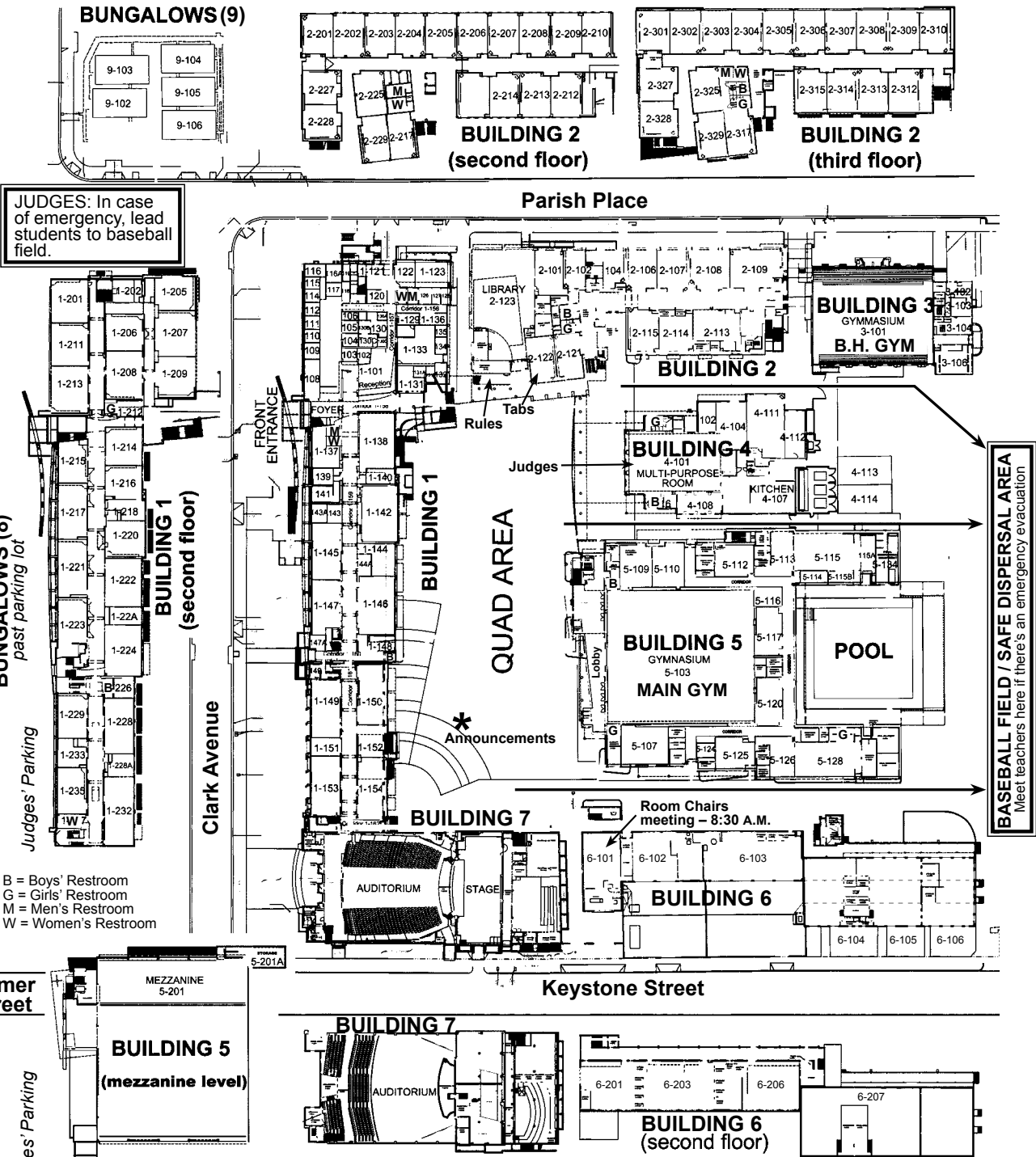

JUDGES: In case of emergency, lead students to baseball field.

BASEBALL FIELD / SAFE DISPERSAL AREA
Meet teachers here if there's an emergency evacuation

B = Boys' Restroom
G = Girls' Restroom
M = Men's Restroom
W = Women's Restroom

Explanation of Room Numbers: The first number is the building. The second number is the floor.
For Example: 6-101 = Building 6, 1st floor. 1-224 = Building 1, 2nd floor. 2-312 = Building 2, 3rd floor.
8-102 = Bungalows back of parking lot. 9-104 = Bungalows across Parish Place.
Please note: Elevators are for adults and handicapped persons only. Cross streets only at crosswalks.

Millikan Middle School

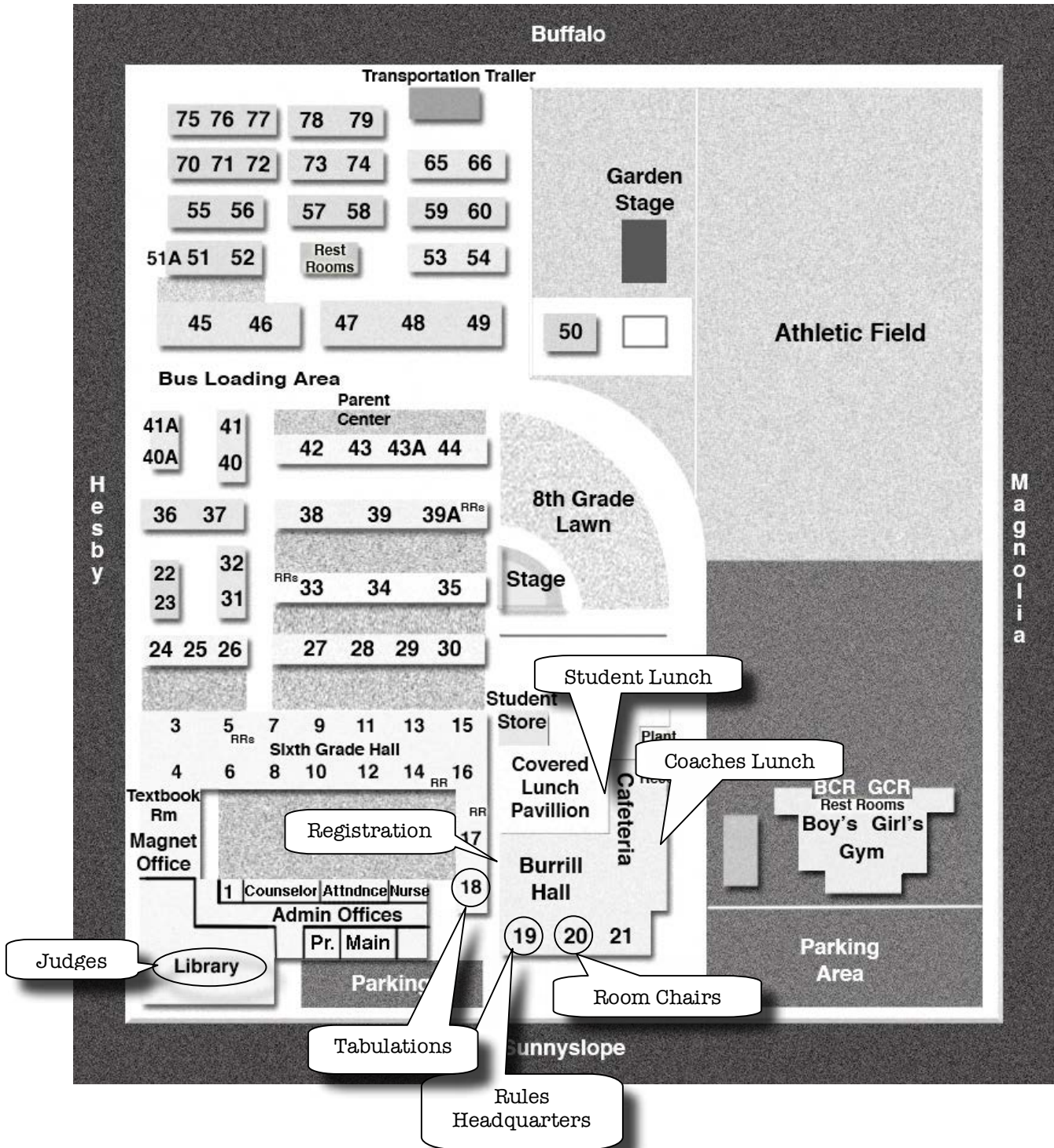

CAMPUS MAP OF PALISADES HIGH SCHOOL, PACIFIC PALISADES

BUS PARKING
IN STADIUM LOT

STUDENT PARKING
UPPER LOT

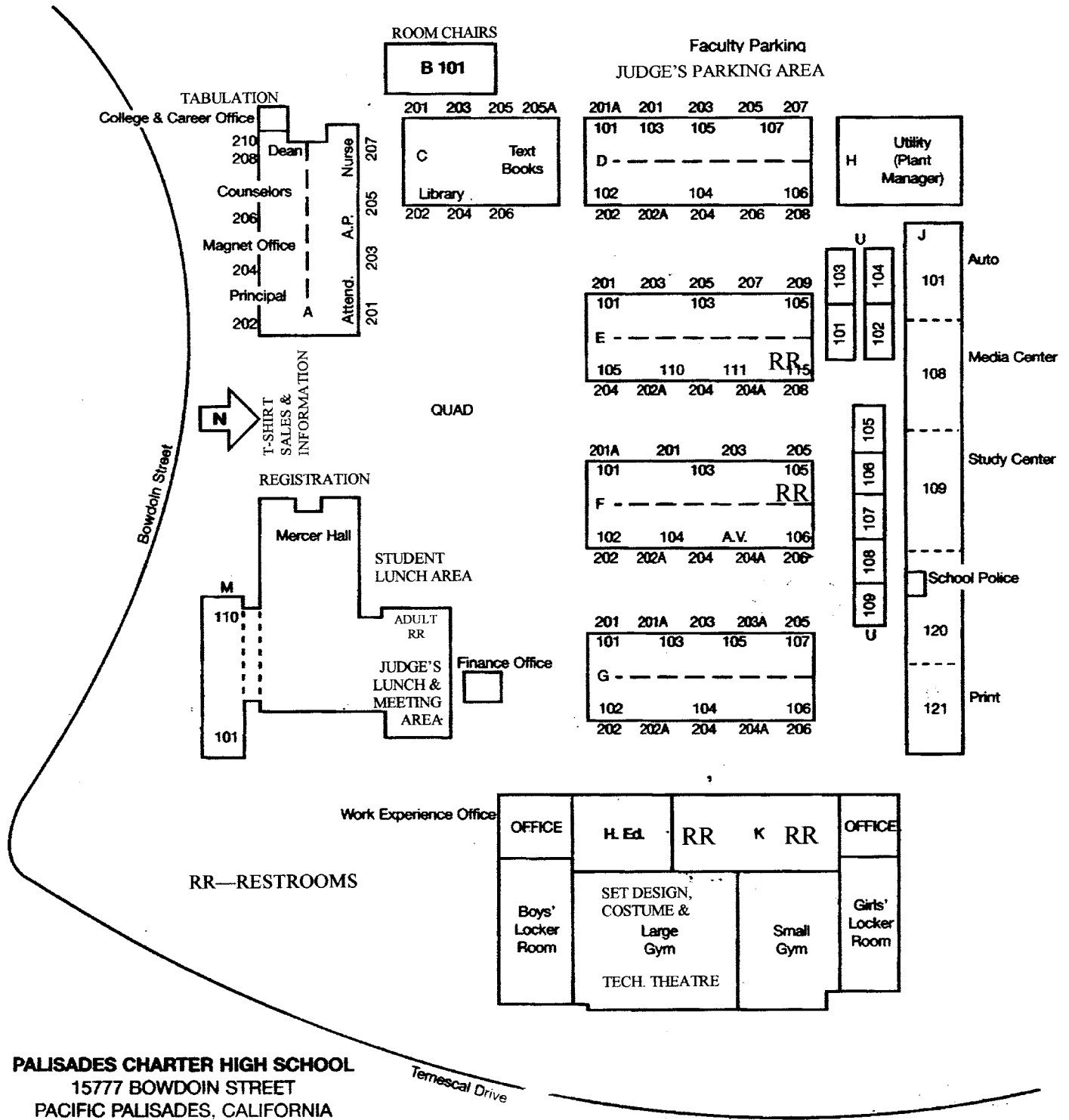

CAMPUS MAP OF RAMON C. CORTINEZ VAPA, LOS ANGELES

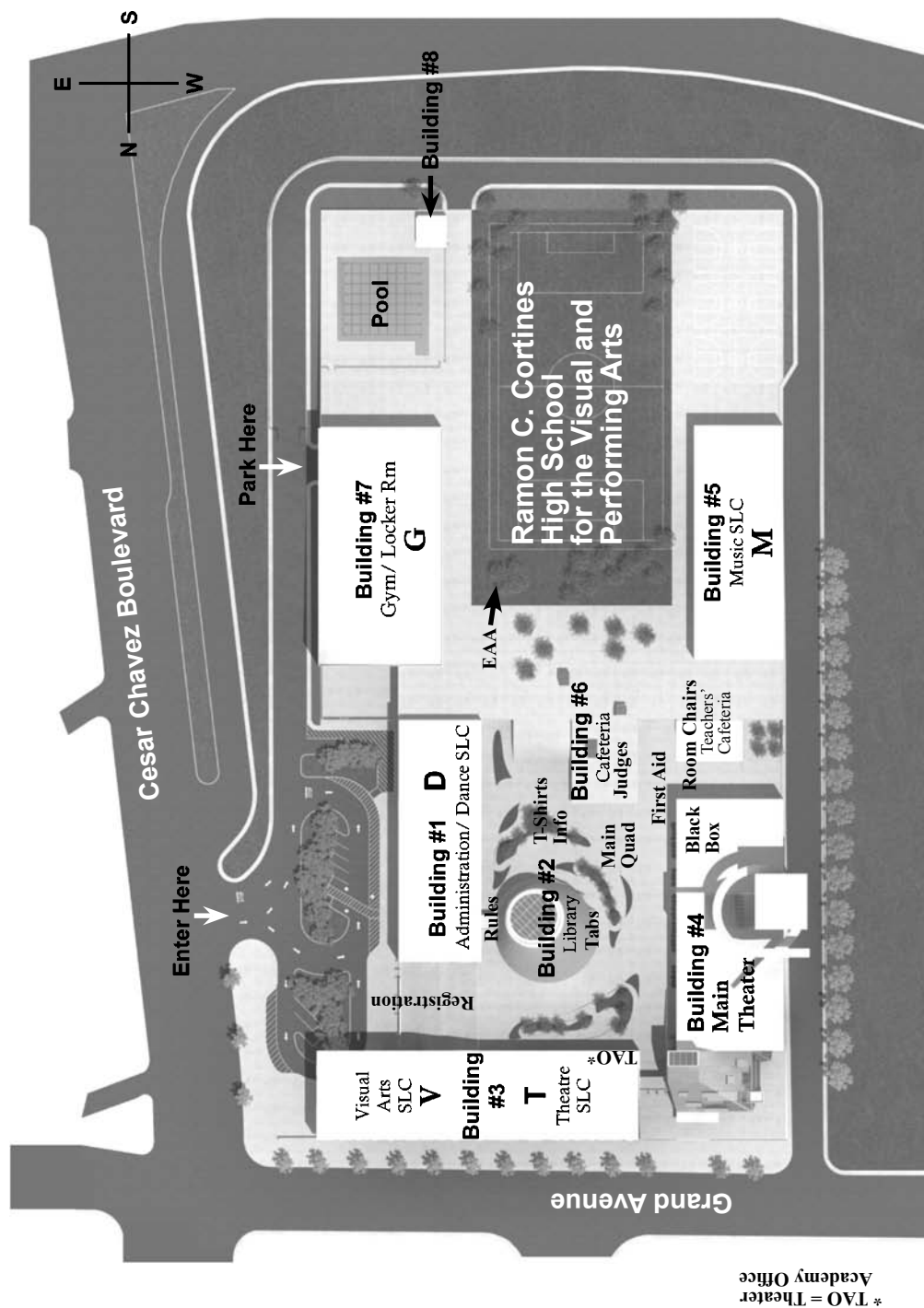

CAMPUS MAP OF RESEDA HIGH SCHOOL, RESEDA

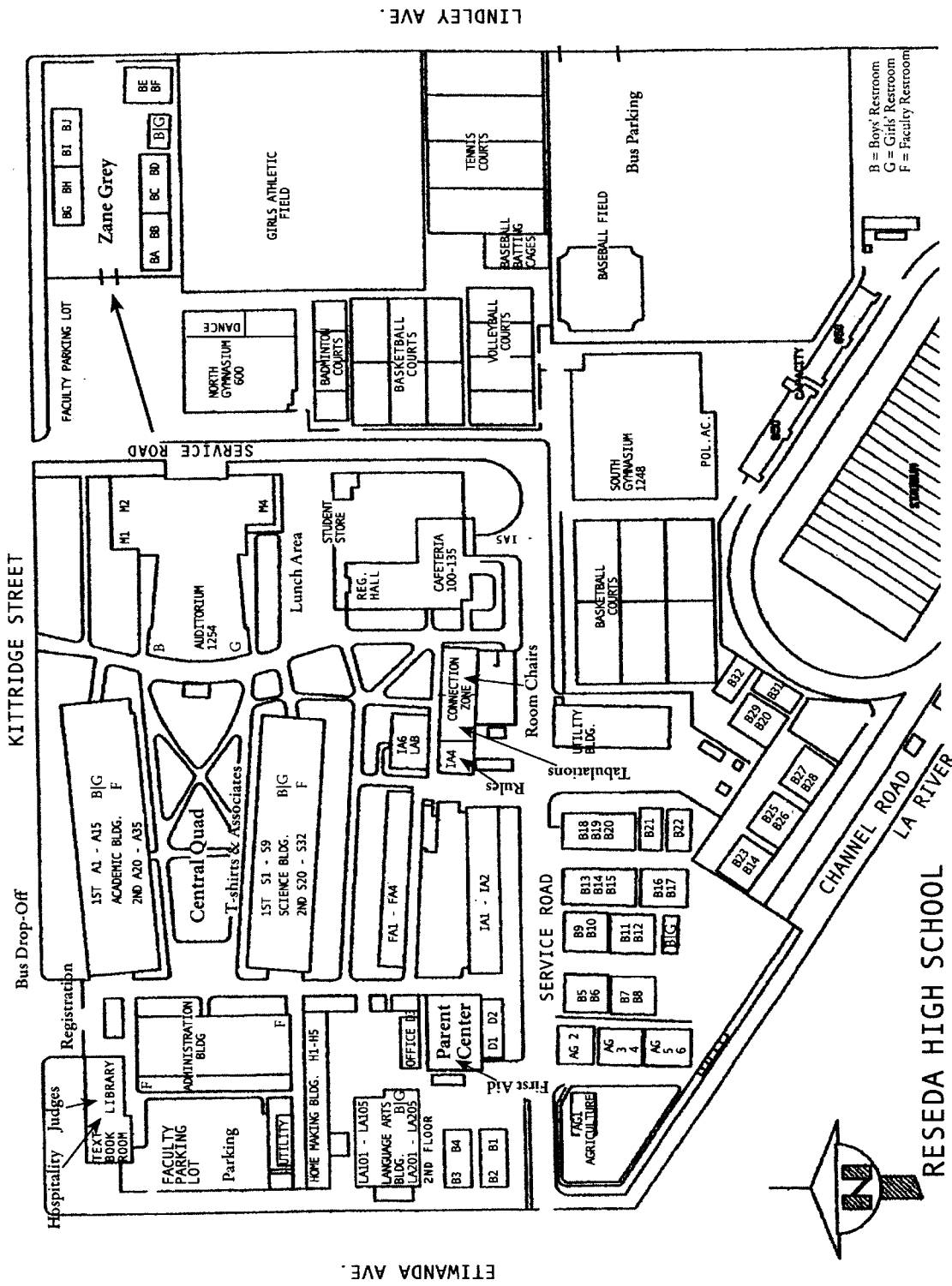

CAMPUS MAP OF SHERMAN OAKS CENTER FOR ENRICHED STUDIES, RESEDA

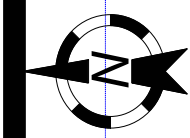

SHERMAN OAKS CENTER FOR ENRICHED STUDIES

18605 Erwin Street Reseda, CA 91335

phone (818) 342-5175

fax (818) 344-5909

24 Hour Knightline (818) 343-7200

Victory Boulevard

Yolanda Avenue

Reseda Boulevard

18605 Erwin Street

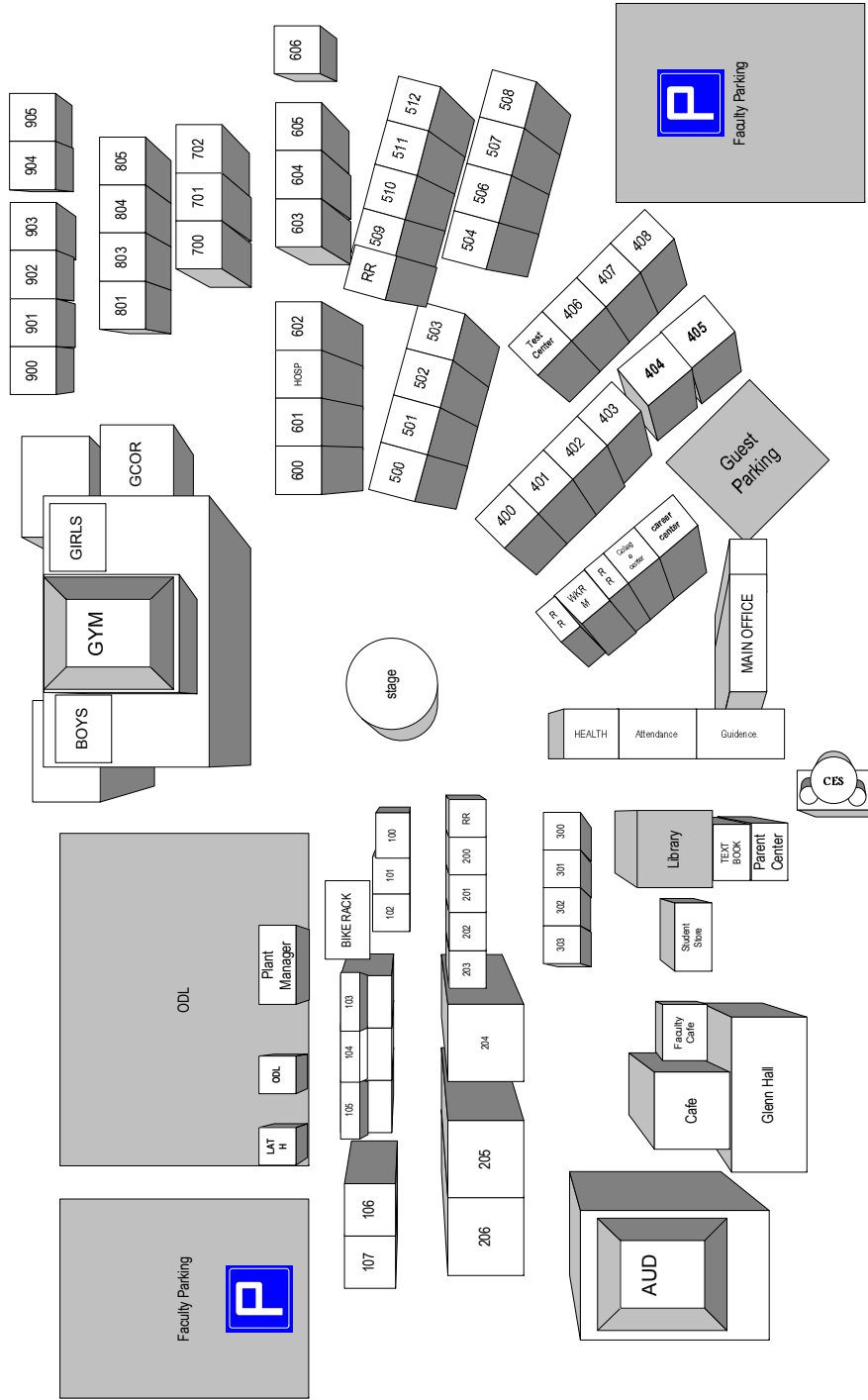

TECHWORKS 2001-2002

CAMPUS MAP OF ST. JOSEPH'S HIGH SCHOOL, LAKEWOOD

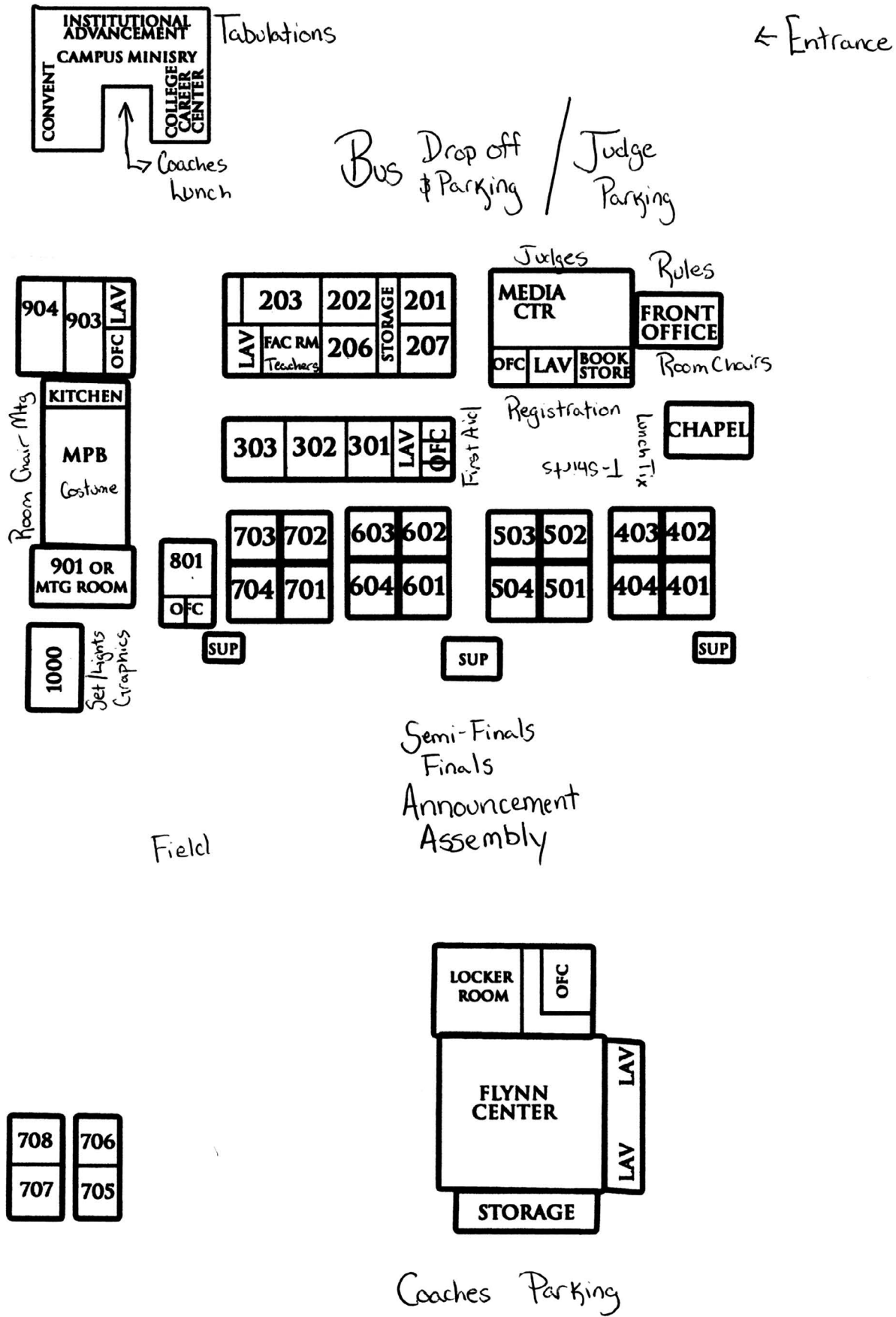

CAMPUS MAP OF SUN VALLEY MIDDLE SCHOOL, SUN VALLEY

VALERIO STREET

Sun Valley Middle School
7330 Bakman Avenue
Sun Valley, California 91352

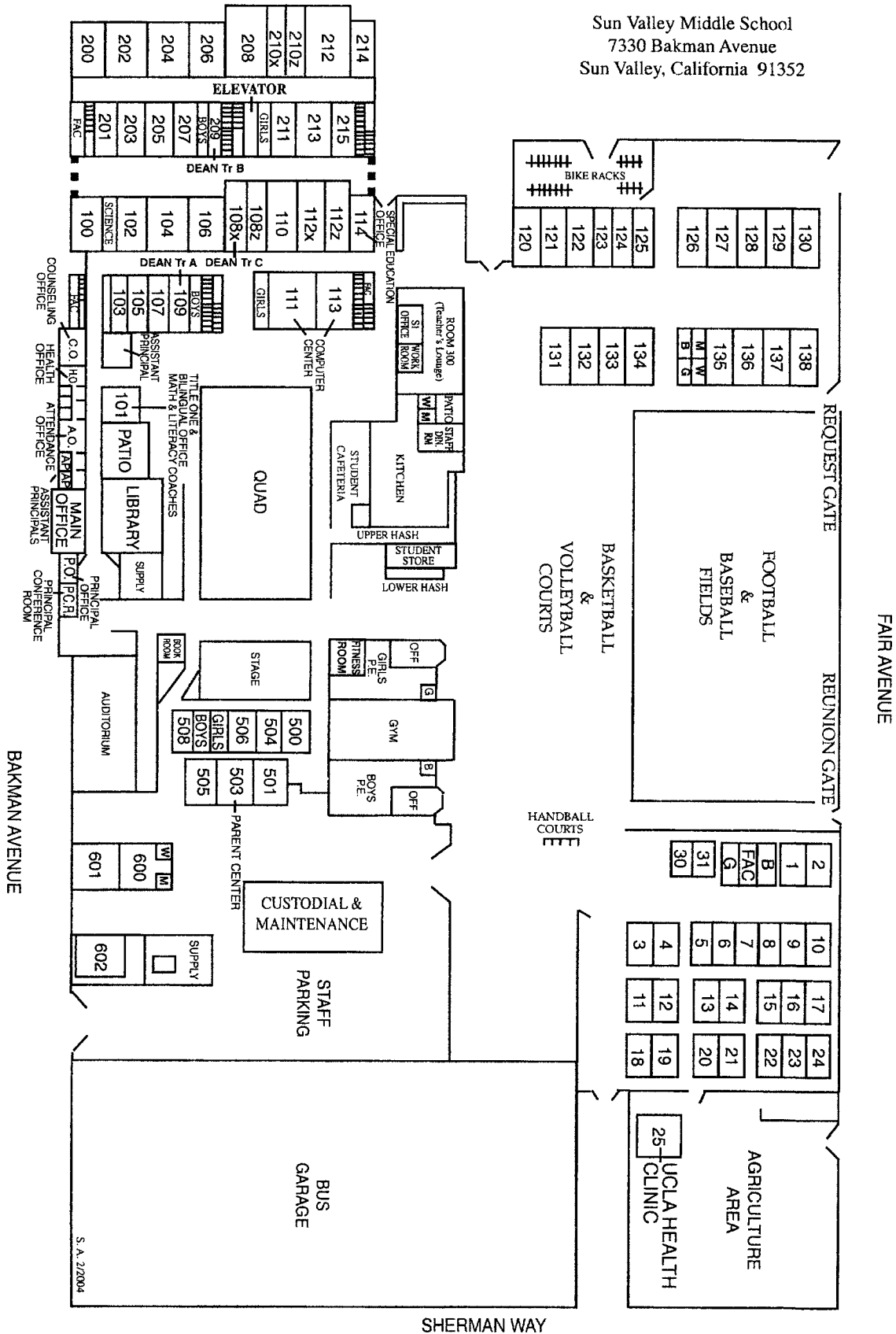

S. A. 2/2004

CAMPUS MAP OF VALENCIA HIGH SCHOOL, PLACENTIA

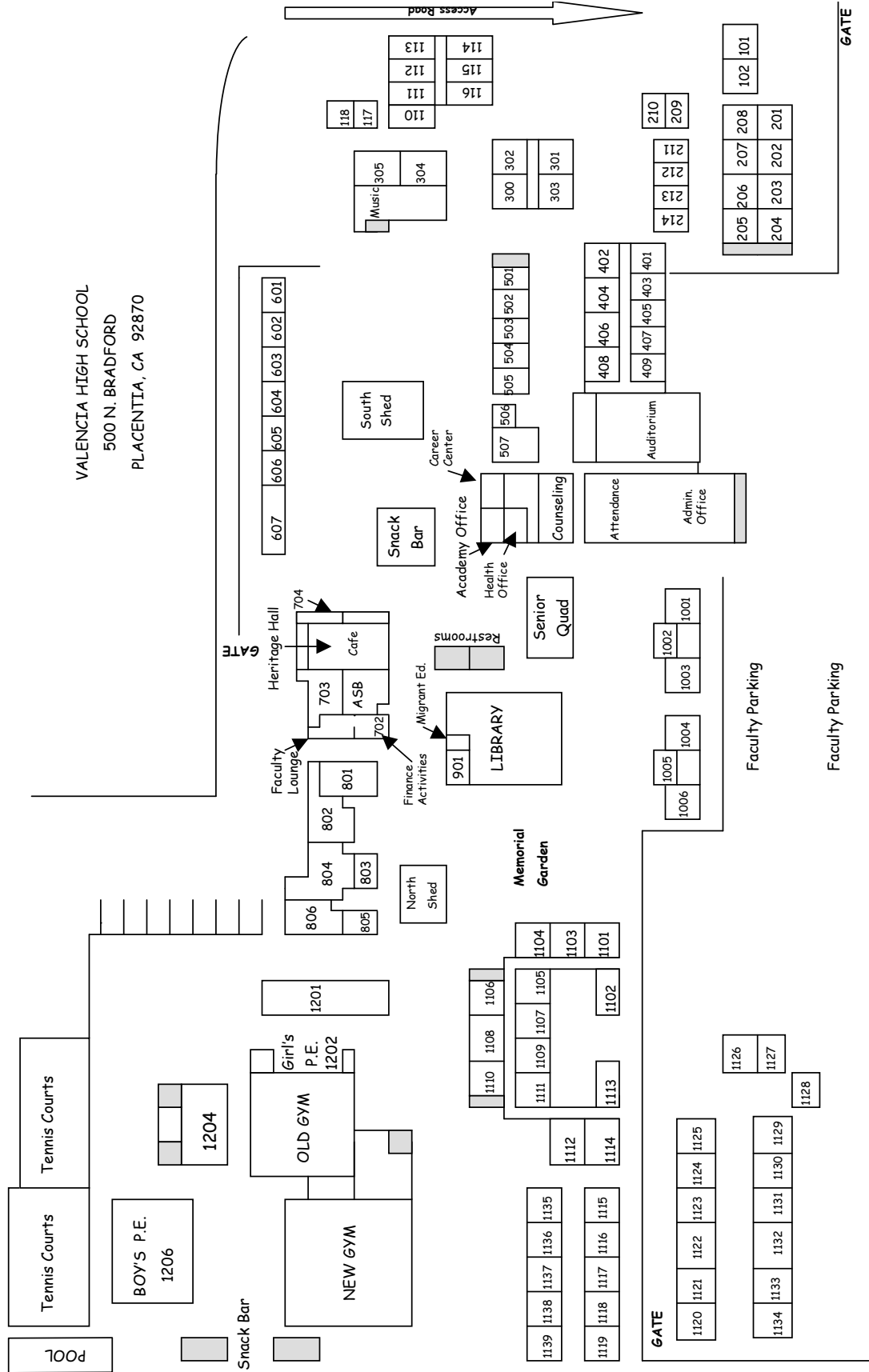

VALENCIA HIGH SCHOOL
500 N. BRADFORD
PLACENTIA, CA 92870

CAMPUS MAP OF VALLEY VIEW MIDDLE SCHOOL, SIMI VALLEY

School Site Plan
VALLEY VIEW MIDDLE SCHOOL

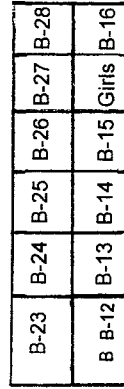
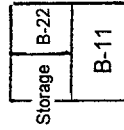
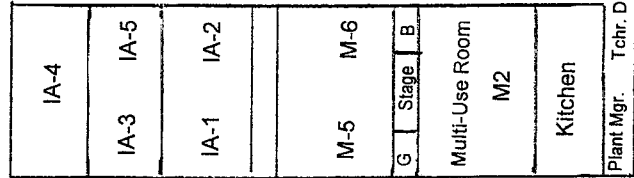
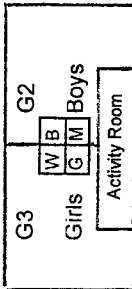
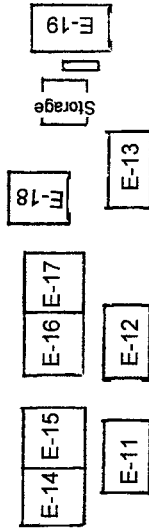
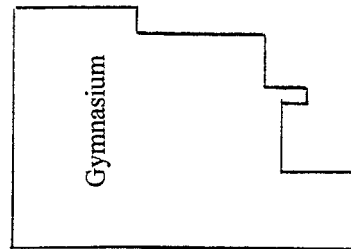

Amphitheater

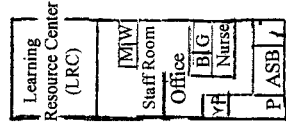
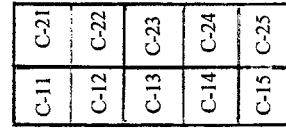
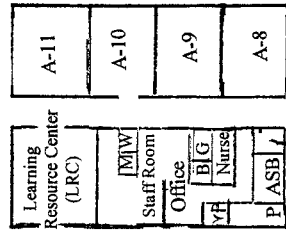

ADA Restroom

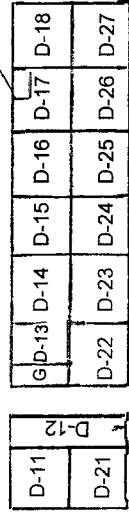

Valley View Middle School
3347 Tapo Street
Simi Valley, Calif. 93063
(805) 520-6820

Tapo Street

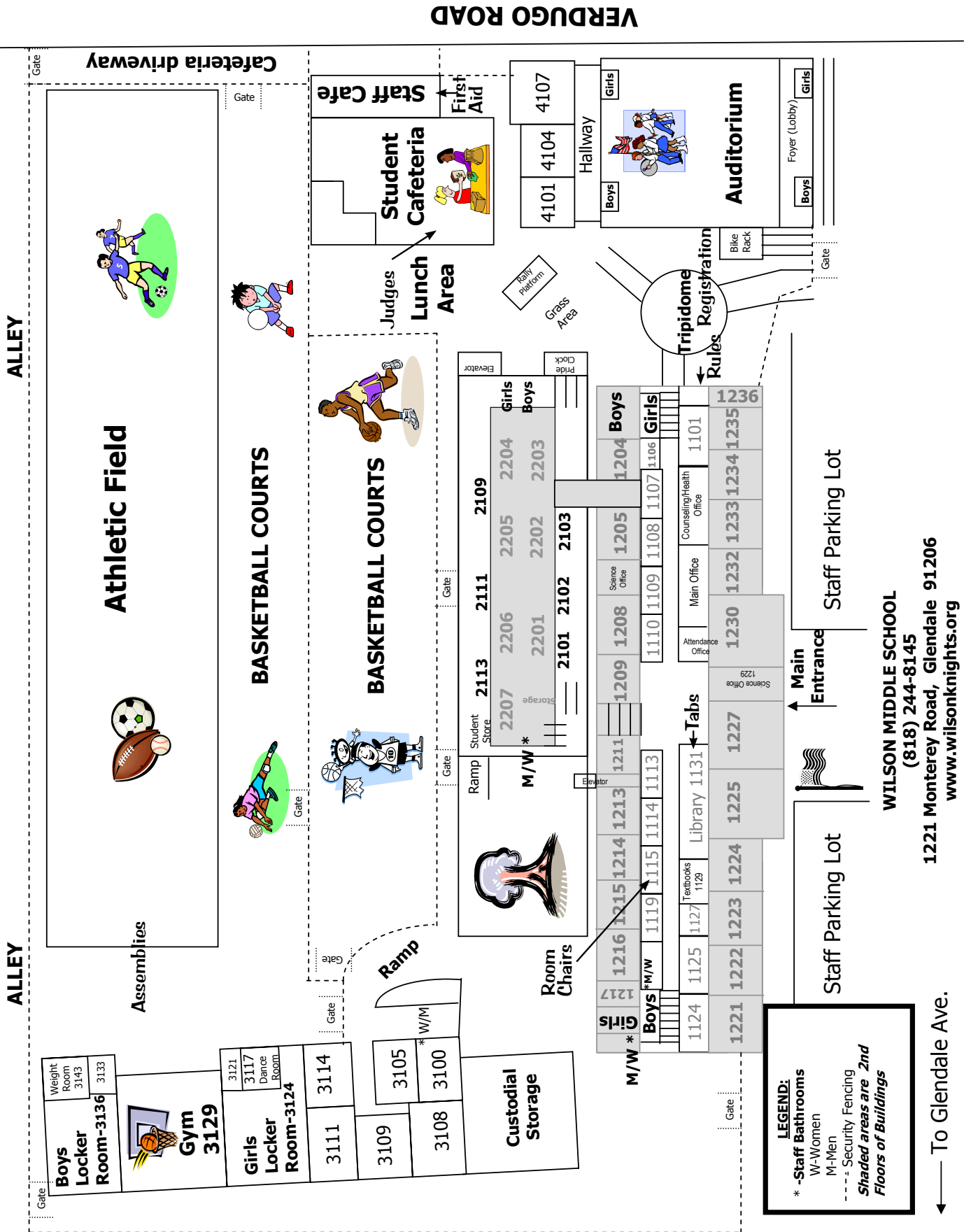

IN AND AROUND HOLLYWOOD

Restaurants: (numbers correspond to map next page)

1. Bar Marmont (Eclectic)
8171 Sunset Blvd. West Hollywood 323-650-0575
2. Café des Artistes (American/French)
1534 N. McCadden Pl. Hollywood 323-469-7300
3. California Pizza Kitchen (American Pizza)
6801 Hollywood Blvd. Hollywood 323-460-2080
4. The Cat and the Fiddle (English, Pub Food)
6530 Sunset Blvd. Hollywood 323-468-3800
5. Dar Maghreb (Moroccan)
7651 Sunset Blvd. Hollywood 323-876-7651
6. Formosa Café (Chinese)
7156 Santa Monica Blvd. Hollywood 323-850-9050
7. Hamburger Hamlet (American, Hamburgers)
6914 Hollywood Blvd. Hollywood 323-467-6106
8. Koji's Sushi and Shabu Shabu Restaurant (Japanese)
6801 Hollywood Blvd. Hollywood 323-871-0200
9. Micelli's (Italian)
1646 N. Las Palmas Blvd. Hollywood 323-466-3438
10. Musso and Frank Grill (American, Steakhouse, Continental)
6667 Hollywood Blvd. Hollywood 323-467-7788
11. Pink's World Famous Hot Dog Stand
711 N. La Brea Ave. Hollywood 323-931-4223
12. Sharkey's Fresh Mexican Grill (Mexican)
1716 Cahuenga Blvd. Hollywood 323-461-7881
13. Sizzler Restaurant (Steak, Seafood, Salad Bar)
1323 N. Highland Ave. Hollywood 323-467-2353
14. Tommy Tang's (Thai)
7313 Melrose Blvd. Hollywood 323-937-5733
15. Wolfgang Puck Café (California Cuisine)
8000 Sunset Blvd. West Hollywood 323-650-7300

